



Changes to the Proposals Map

North Dorset Local Plan Part 1

January 2016

1. Introduction

- 1.1 This document includes a set of maps that shows the changes to the Proposals Map of the North Dorset District Wide Local Plan (2003).
- 1.2 Policy 2 – Core Spatial Strategy of the North Dorset Local Plan Part 1 states that the settlement boundaries around the four main towns, Stalbridge and the eighteen larger villages will be retained. The settlement boundaries will be retained unaltered around Blandford Forum, Blandford St Mary, Shaftesbury, Sturminster Newton, Stalbridge and the eighteen larger villages.
- 1.3 The settlement boundary around Gillingham will be retained unaltered except to the south of the town, where it will be amended to accommodate growth in the form of a Strategic Site Allocation (SSA). The retained settlement boundaries will continue to be used for development management purposes until reviewed either through the North Dorset Local Plan Review or a neighbourhood plan.

Gillingham Southern Extension

- 1.4 The first map in this document is the Gillingham Southern Extension Proposals Map, which shows both the amended settlement boundary and the proposals for the development of the SSA. This map also appears as Figure 9.5 in the North Dorset Local Plan Part 1.

Removed Settlement Boundaries

- 1.5 Other maps show the boundaries of other settlements in the District that will be removed from the Proposals Map. A list of the settlements where the boundaries will be removed appears in Figure B.1 (Appendix B) of the North Dorset Local Plan Part 1.

Gillingham Southern Extension

-  Settlement Boundary - Policy 21 and saved policy 1.7
-  Existing Employment Area - Policy 21 and saved policies 3.2 and GH8
-  Housing Growth (incorporating open space and landscaping) - Policy 21
-  Employment Growth - Policy 21
-  River Corridors (Informal Open Space) - Policy 21
-  Shaftesbury Road Corridor (Local Centre) - Policy 21

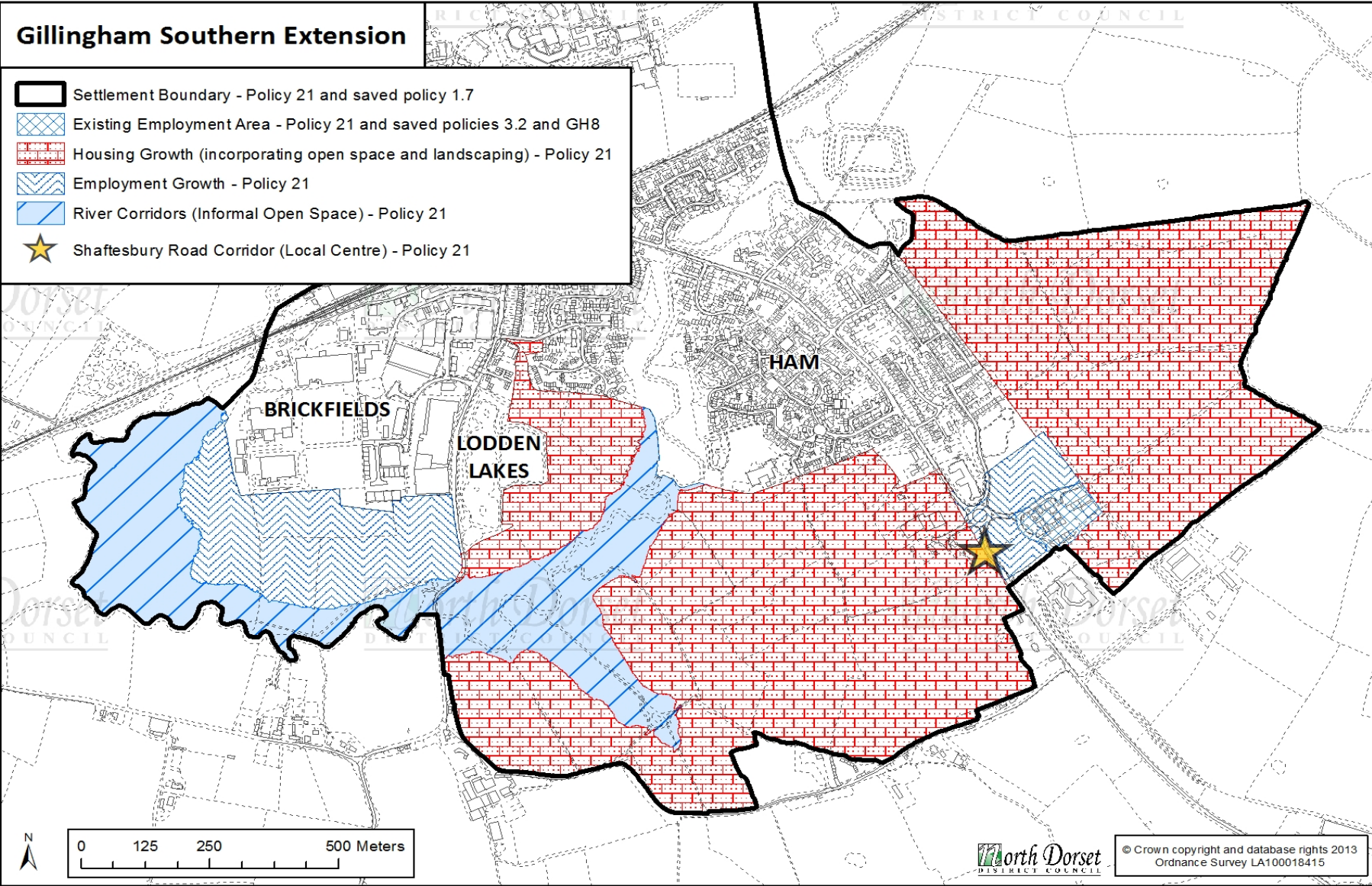









ASHMORE

PROPOSALS MAP

INSET No.

1

Policy Ref:

	Settlement Boundary	1.7
	Important Open or Wooded Areas	1.9
	Groundwater Source Protection	1.16
	Conservation Area	1.24 - 27
	Sites of Archaeological Importance	1.28 - 30
Whole Area	Area of Outstanding Natural Beauty (AONB)	1.32
Inset Plan Area	Chalk Uplands Landscape Character Area	1.33
	Environmentally Sensitive Area	1.33
	Wessex Ridgeway	4.10
	North Dorset Cycleway	4.10

Ashmore

AONB

Settlement boundary removed

CHALK UPLANDS (CRANBORNE CHASE)

AONB



Norden, Salisbury Road, Blandford Forum, Dorset DT11 7LL
 Telephone (01258) 454111 | Fax (01258) 480179

NORTH DORSET DISTRICT - WIDE LOCAL PLAN (1st Revision)

© Crown copyright and database rights 2013
 Ordnance Survey LA100018415

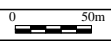
Scale  Adopted: Jan. 2003

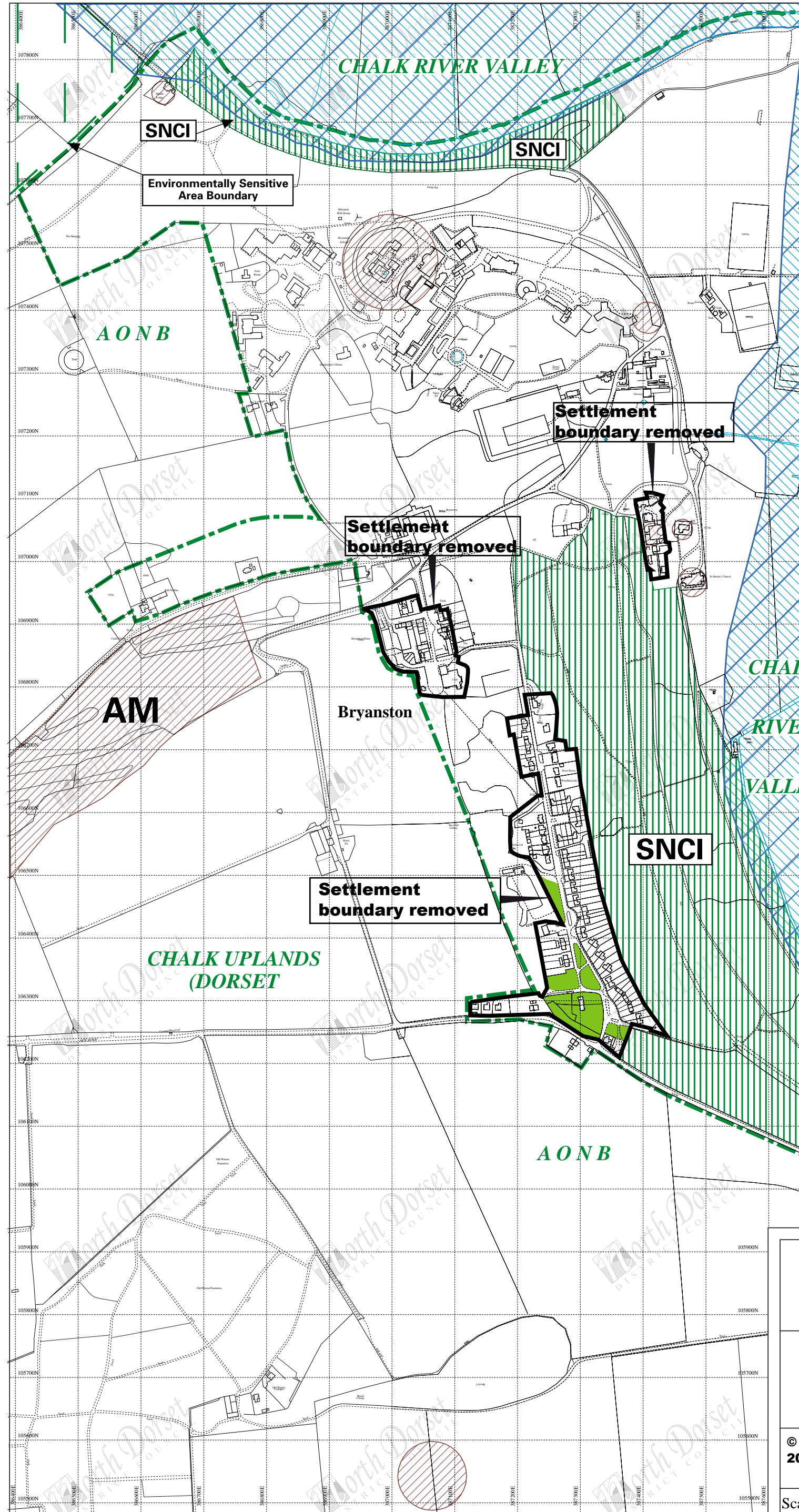

BRYANSTON		PROPOSALS MAP
		INSET No. 4
		Policy Ref:
	Settlement Boundary	1.7
	Important Open or Wooded Areas	1.9
	River Valley Area & Area Liable to Flood	1.12 - 13
	Conservation Area	1.24 - 27
	Ancient Monument (AM) & Site of Archaeological Importance	1.28 - 30
Whole Inset Plan Area	Area of Outstanding Natural Beauty (AONB)	1.32
	Part Chalk River Valley and Part Chalk Uplands Landscape Character Areas	1.33
	Site of Nature Conservation Interest	1.34 - 36
	Environmentally Sensitive Area	1.33

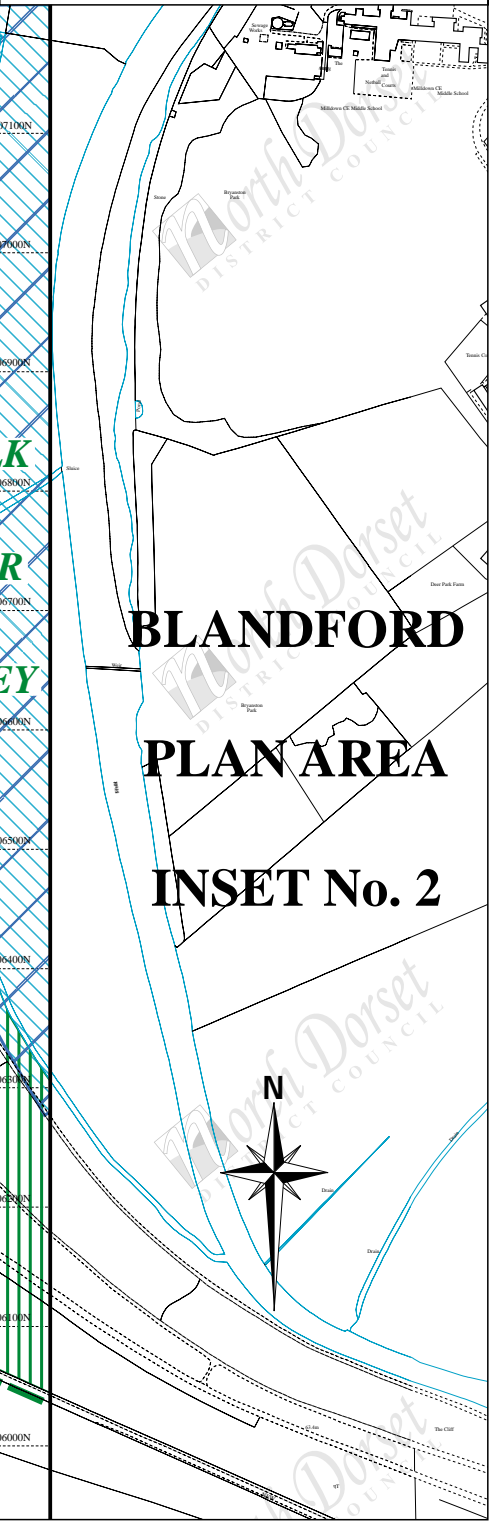

North Dorset DISTRICT COUNCIL
 Nordon, Salisbury Road, Blandford Forum, Dorset DT11 7LL
 Telephone (01258) 454111 Fax (01258) 480179

NORTH DORSET DISTRICT - WIDE LOCAL PLAN (1st Revision)





© Crown copyright and database rights 2013 Ordnance Survey LA100018415

Scale Adopted: Jan. 2003

BUCKHORN WESTON

PROPOSALS MAP

INSET No.
5

	Railtrack	Policy Ref: Para. 1. 32
	Settlement Boundary	1. 7
	Important Open or Wooded Areas	1. 9
	Sites of Archaeological Importance	1.28 - 30
Whole	Part Limestone Ridges and Part Blackmore Vale Landscape Character Areas	1. 33
Inset	Rural Priority Area (RPA)	3. 1
Plan Area	North Dorset Cycleway	4. 10

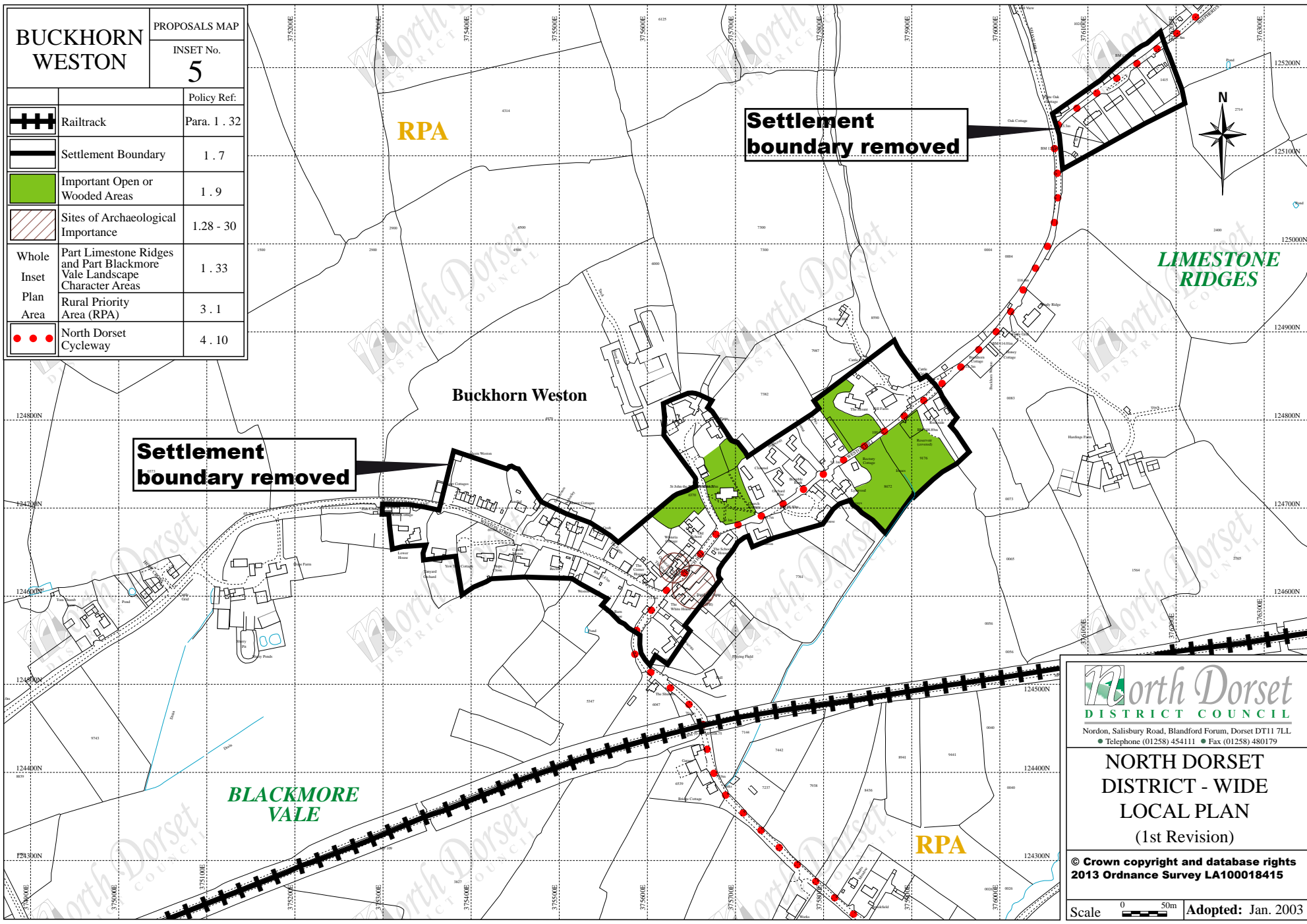

North Dorset
DISTRICT COUNCIL
Norden, Salisbury Road, Blandford Forum, Dorset DT11 7LL
● Telephone (01258) 454111 ● Fax (01258) 480179

NORTH DORSET DISTRICT - WIDE LOCAL PLAN (1st Revision)

© Crown copyright and database rights
2013 Ordnance Survey LA100018415

Scale 0 50m Adopted: Jan. 2003

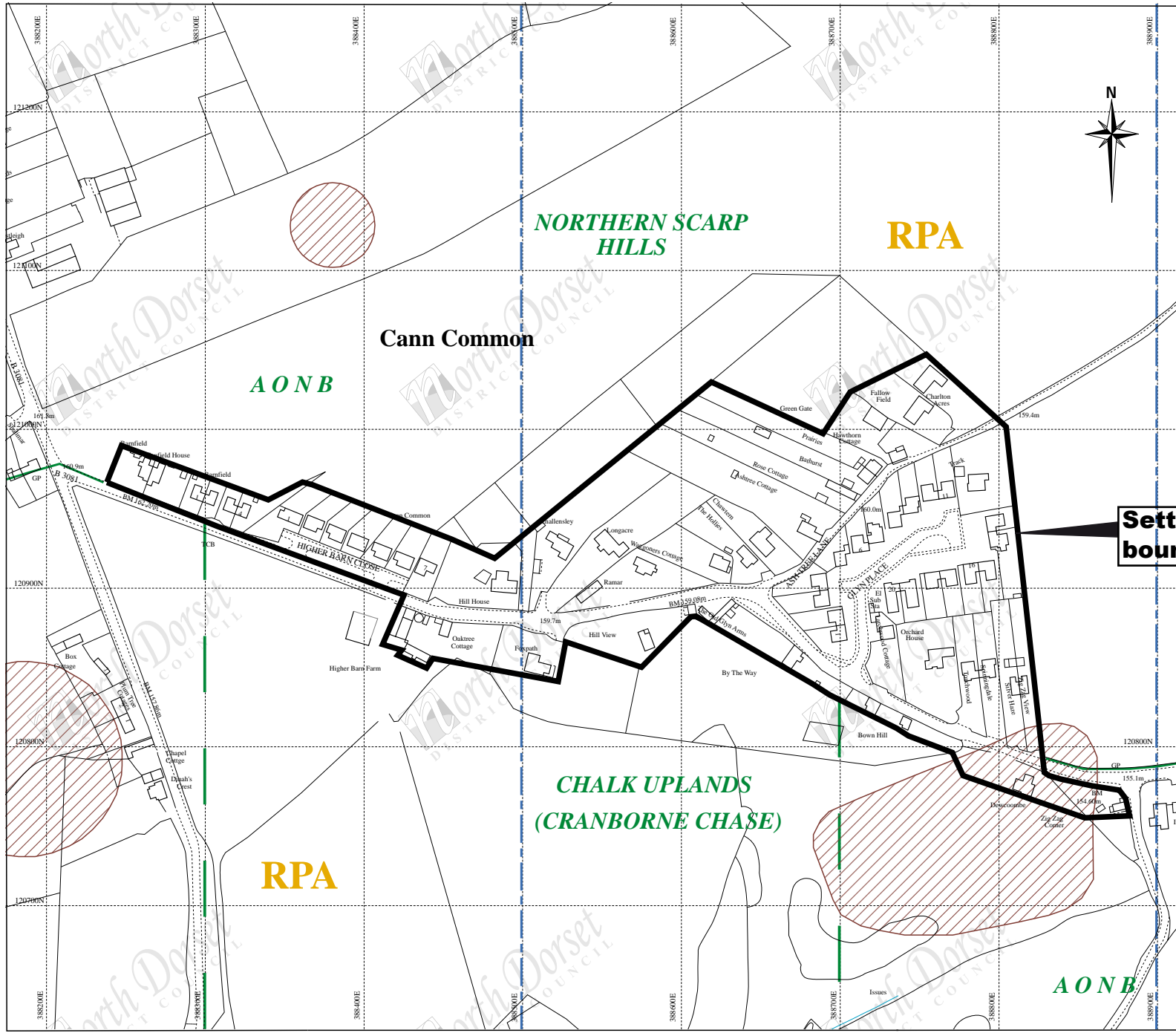

CANN COMMON		PROPOSALS MAP
		INSET No. 6
		Policy Ref:
	Settlement Boundary	1. 7
	Ground Water Source Protection Area	1. 16
	Site of Archaeological Importance	1.28 - 30
Whole Inset Plan Area	Area of Outstanding Natural Beauty	1. 32
	Part Northern Scarp Hills & Part Chalk Uplands Landscape Character Areas	1. 33
	Rural Priority Area (RPA)	3. 1
	Environmentally Sensitive Area	1. 33

Settlement boundary removed

North Dorset DISTRICT COUNCIL
 Nordon, Salisbury Road, Blandford Forum, Dorset DT11 7LL
 • Telephone (01258) 454111 • Fax (01258) 480179

NORTH DORSET DISTRICT - WIDE LOCAL PLAN (1st Revision)









© Crown copyright and database rights 2013 Ordnance Survey LA100018415

Scale Adopted: Jan. 2003

COMPTON ABBAS

PROPOSALS MAP

INSET No.
9

	Regular Frequency Bus Route	Para.1.32
	Existing Distributor Route	Para.1.32
	Settlement Boundary	1.7
	Important Open or Wooded Area	1.9
	Conservation Area	1.24 - 27
	Sites of Archaeological Importance	1.28 - 30
	Area of Outstanding Natural Beauty	1.32
	Part Chalk Uplands Part Blackmore Vale Landscape Character Areas	1.33
	Rural Priority Area (RPA)	3.1
	Special Areas of Conservation (SAC) and Sites of Special Scientific Interest (SSSI)	1.34 - 36
	Environmentally Sensitive Area	1.33

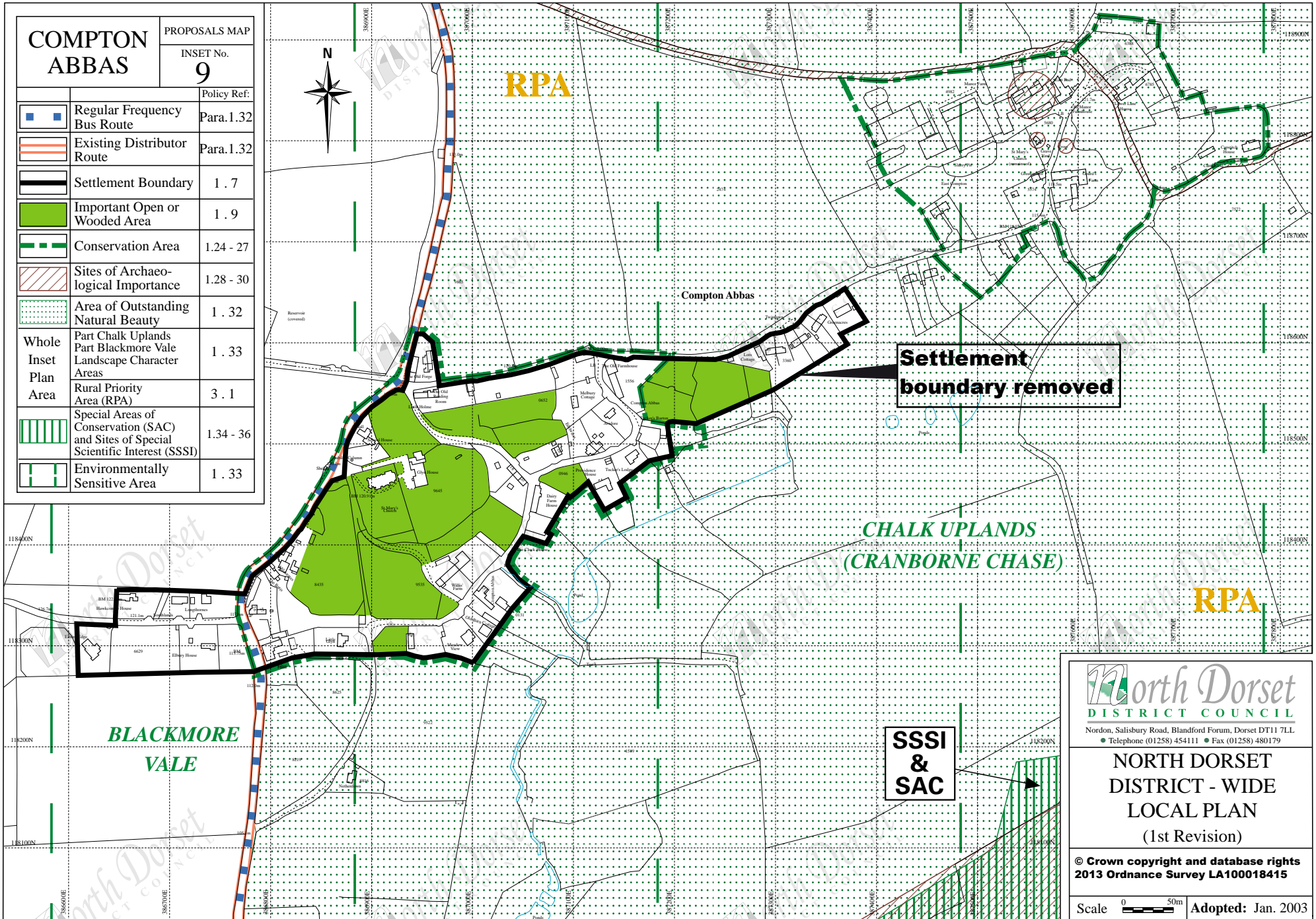

Settlement boundary removed

CHALK UPLANDS (CRANBORNE CHASE)

RPA

BLACKMORE VALE

SSSI & SAC

North Dorset DISTRICT COUNCIL

Nordon, Salisbury Road, Blandford Forum, Dorset DT11 7LL
 Telephone (01258) 454111 Fax (01258) 480179

NORTH DORSET DISTRICT - WIDE LOCAL PLAN (1st Revision)

© Crown copyright and database rights 2013 Ordnance Survey LA100018415

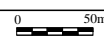
Scale  Adopted: Jan. 2003

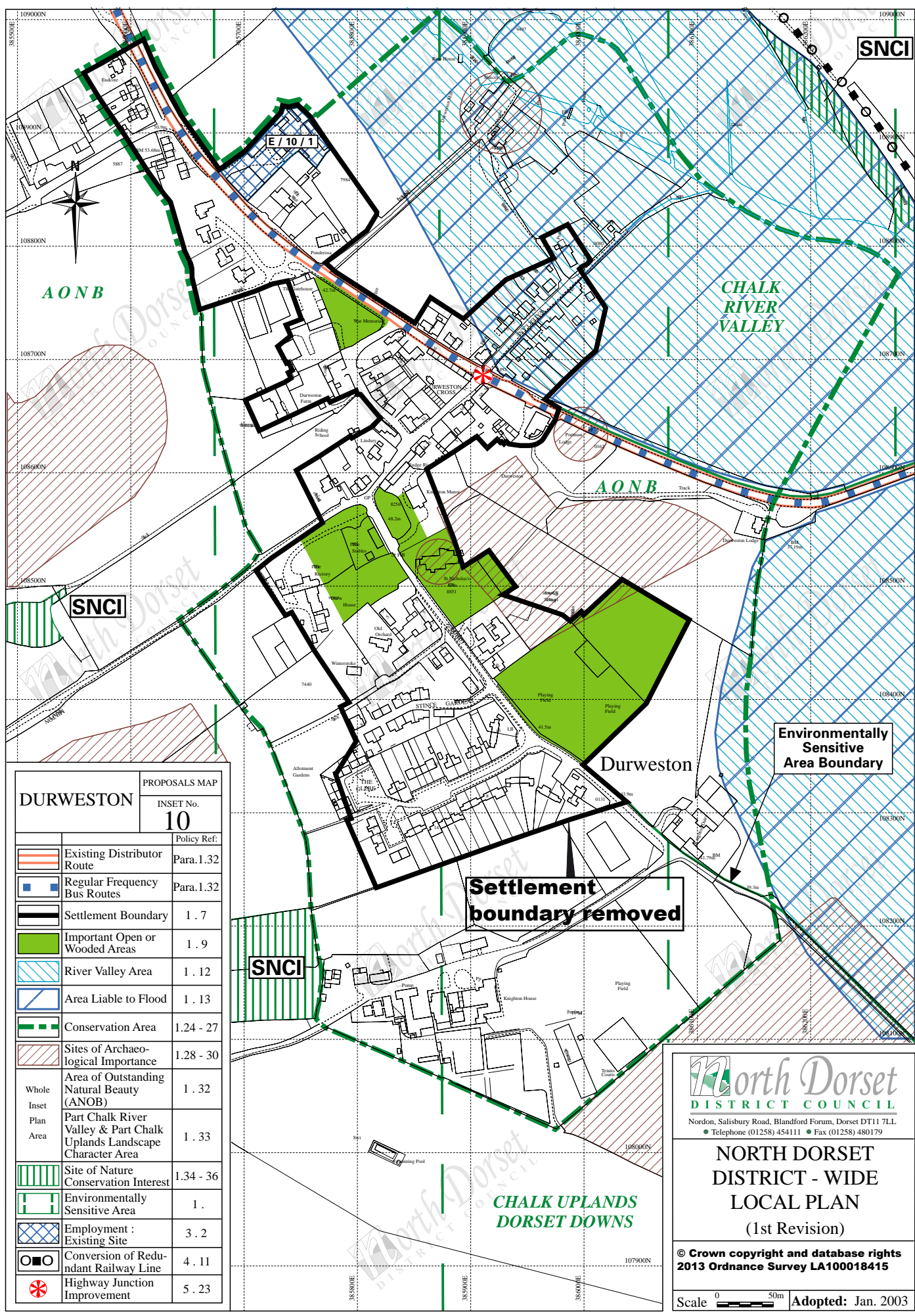

DURWESTON

PROPOSALS MAP
INSET No.
10

	Policy Ref:
	Existing Distributor Route Para. 1.32
	Regular Frequency Bus Routes Para. 1.32
	Settlement Boundary 1.7
	Important Open or Wooded Areas 1.9
	River Valley Area 1.12
	Area Liable to Flood 1.13
	Conservation Area 1.24 - 27
	Sites of Archaeological Importance 1.28 - 30
	Area of Outstanding Natural Beauty (AONB) 1.32
	Part Chalk River Valley & Part Chalk Uplands Landscape Character Area 1.33
	Site of Nature Conservation Interest 1.34 - 36
	Environmentally Sensitive Area 1.
	Employment : Existing Site 3.2
	Conversion of Redundant Railway Line 4.11
	Highway Junction Improvement 5.23

Settlement boundary removed

Environmentally Sensitive Area Boundary

North Dorset
DISTRICT COUNCIL

Nordon, Salisbury Road, Blandford Forum, Dorset DT11 7LL
● Telephone (01258) 454111 ● Fax (01258) 480179

NORTH DORSET DISTRICT - WIDE LOCAL PLAN
(1st Revision)

© Crown copyright and database rights
2013 Ordnance Survey LA100018415

Scale 50m **Adopted: Jan. 2003**

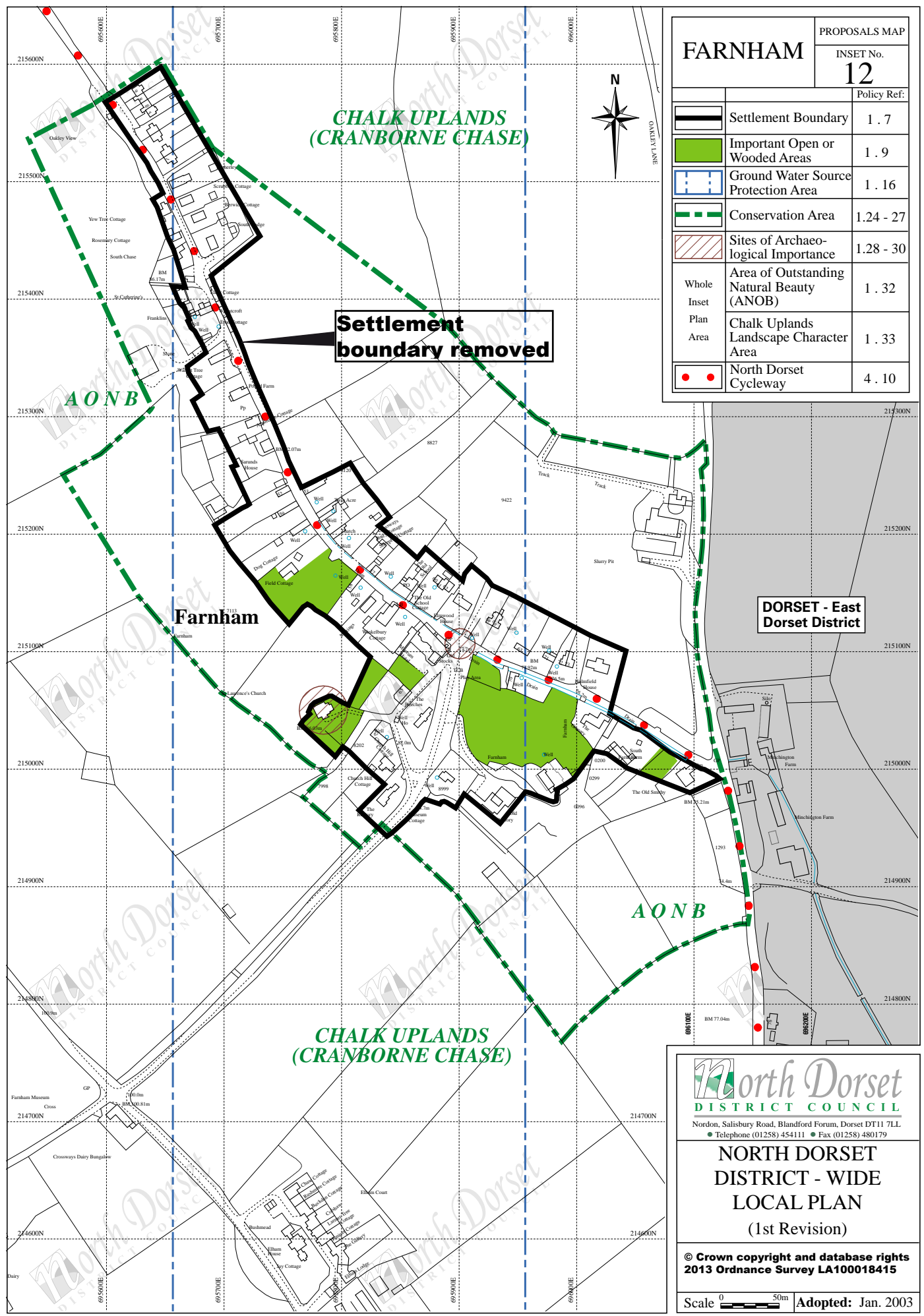

FARNHAM		PROPOSALS MAP
		INSET No. 12
		Policy Ref:
	Settlement Boundary	1.7
	Important Open or Wooded Areas	1.9
	Ground Water Source Protection Area	1.16
	Conservation Area	1.24 - 27
	Sites of Archaeological Importance	1.28 - 30
Whole Inset Plan Area	Area of Outstanding Natural Beauty (ANOB)	1.32
	Chalk Uplands Landscape Character Area	1.33
	North Dorset Cycleway	4.10

Settlement boundary removed

DORSET - East Dorset District

North Dorset DISTRICT COUNCIL
 Nordon, Salisbury Road, Blandford Forum, Dorset DT11 7LL
 Telephone (01258) 454111 Fax (01258) 480179

NORTH DORSET DISTRICT - WIDE LOCAL PLAN (1st Revision)

© Crown copyright and database rights 2013 Ordnance Survey LA100018415

Scale Adopted: Jan. 2003



FIFEHEAD MAGDALEN		PROPOSALS MAP
		INSET No.
		13
		Policy Ref:
	Settlement Boundary	1.7
	Important Open or Wooded Areas	1.9
	Sewage Treatment Works Protection Area	1.17
	Conservation Area	1.24 - 27
	Sites of Archaeological Importance	1.28 - 30
Whole Inset Plan Area	Limestone Ridges Landscape Character Area	1.33
	Rural Priority Area (RPA)	3.1
	Site of Nature Conservation Interest	1.35 - 36
	Housing : Committed Site	2.1
	North Dorset Cycleway	4.10

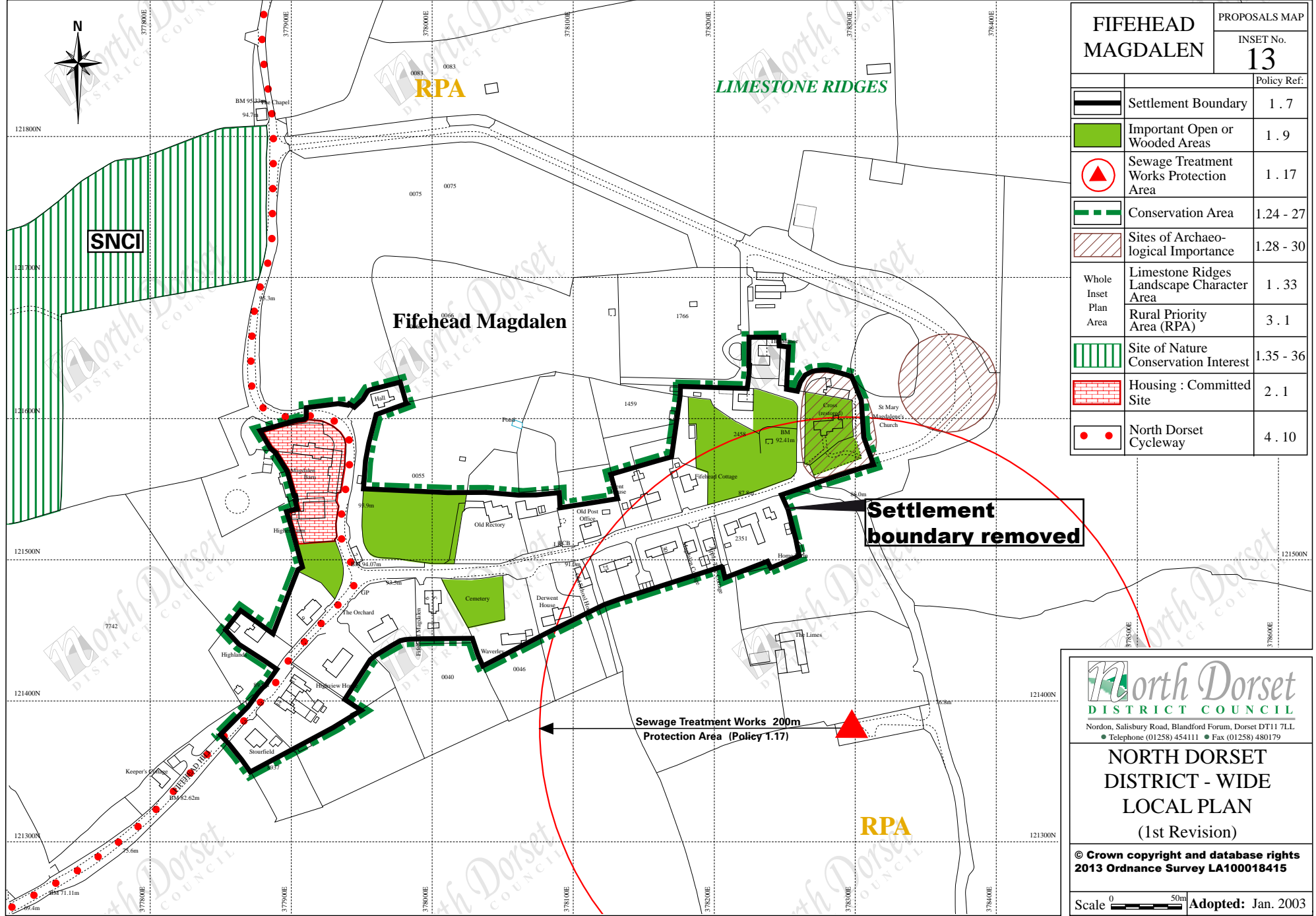

North Dorset
DISTRICT COUNCIL

Nordon, Salisbury Road, Blandford Forum, Dorset DT11 7LL
 ● Telephone (01258) 454111 ● Fax (01258) 480179

NORTH DORSET DISTRICT - WIDE LOCAL PLAN
(1st Revision)

© Crown copyright and database rights
2013 Ordnance Survey LA100018415

Scale Adopted: Jan. 2003



GLANVILLES WOOTTON

PROPOSALS MAP

INSET No.

16

Policy Ref:

	Settlement Boundary	1.7
	Important Open or Wooded Areas	1.9
	Sites of Archaeological Importance	1.28 - 30
Whole Inset Plan Area	Blackmore Vale Landscape Character Area	1.33
	Rural Priority Area (RPA)	3.1

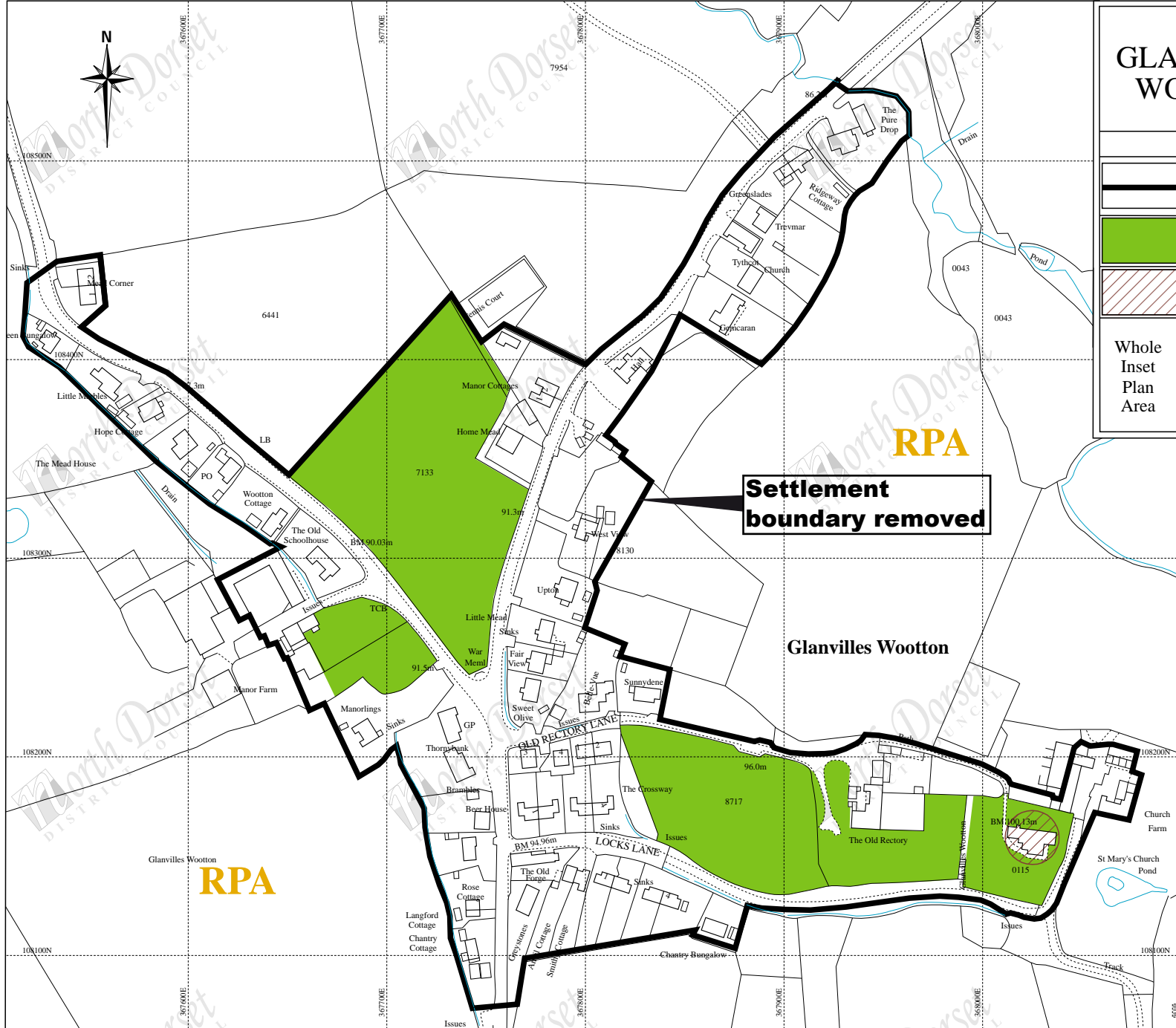

RPA

Settlement boundary removed

Glanvilles Wootton

RPA

North Dorset DISTRICT COUNCIL
 Nordon, Salisbury Road, Blandford Forum, Dorset DT11 7LL
 Telephone (01258) 454111 Fax (01258) 480179

NORTH DORSET DISTRICT - WIDE LOCAL PLAN (1st Revision)

© Crown copyright and database rights 2013 Ordnance Survey LA100018415

Scale 0 50m Adopted: Jan. 2003

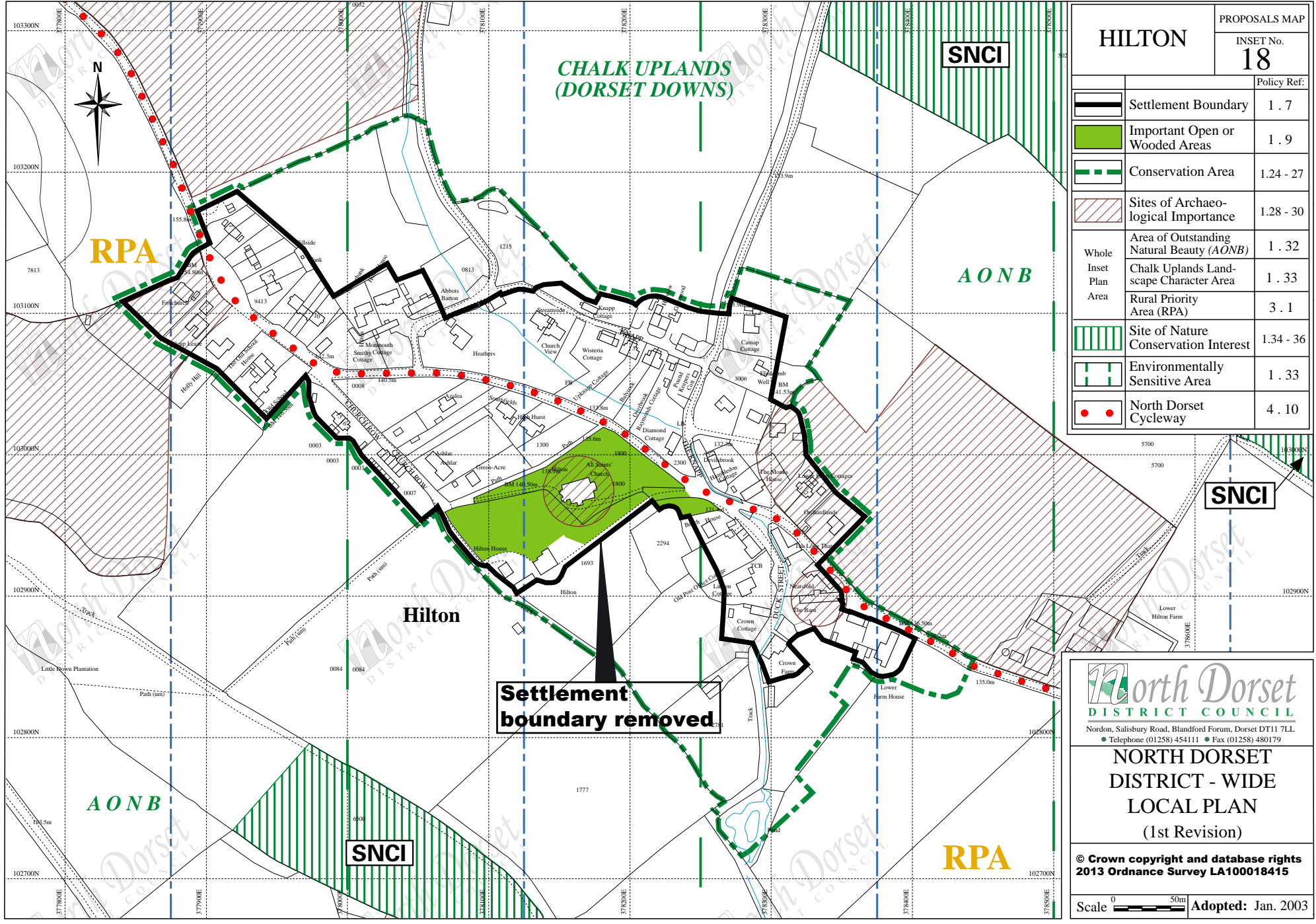

HILTON		PROPOSALS MAP
		INSET No.
		18
		Policy Ref:
	Settlement Boundary	1 . 7
	Important Open or Wooded Areas	1 . 9
	Conservation Area	1.24 - 27
	Sites of Archaeological Importance	1.28 - 30
Whole Inset Plan Area	Area of Outstanding Natural Beauty (AONB)	1 . 32
	Chalk Uplands Landscape Character Area	1 . 33
	Rural Priority Area (RPA)	3 . 1
	Site of Nature Conservation Interest	1.34 - 36
	Environmentally Sensitive Area	1 . 33
	North Dorset Cycleway	4 . 10

Settlement boundary removed

North Dorset DISTRICT COUNCIL
 Nordon, Salisbury Road, Blandford Forum, Dorset DT11 7LL
 Telephone (01258) 454111 Fax (01258) 480179

NORTH DORSET DISTRICT - WIDE LOCAL PLAN (1st Revision)

© Crown copyright and database rights 2013 Ordnance Survey LA100018415

Scale Adopted: Jan. 2003

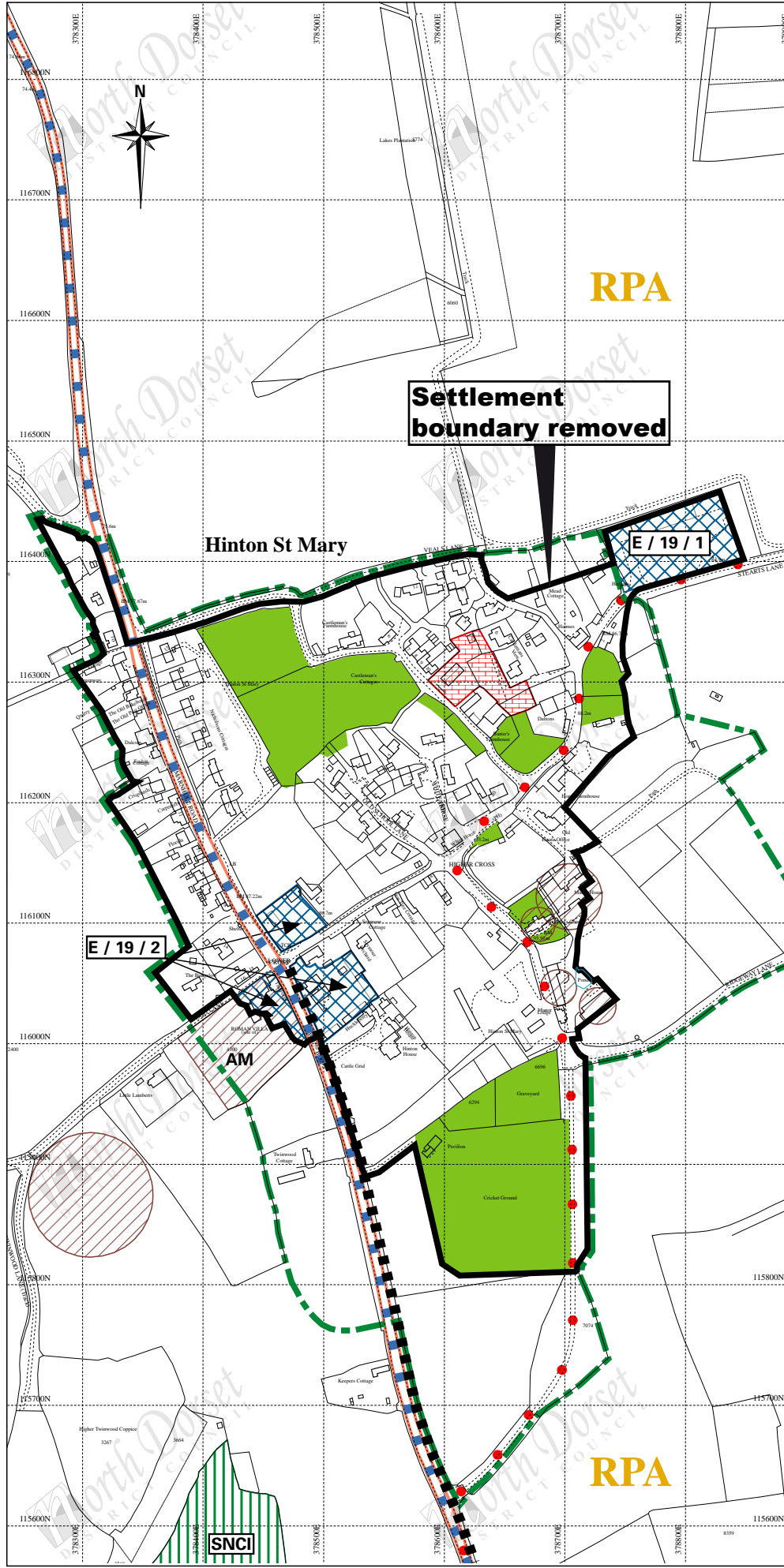

HINTON ST. MARY		PROPOSALS MAP
		INSET No.
		19
		Policy Ref:
	Regular Frequency Bus Route	Para.1.32
	Existing Distributor Route	Para.1.32
	Settlement Boundary	1.7
	Important Open or Wooded Areas	1.9
	Conservation Area	1.24 - 27
	Ancient Monuments (AM) & Sites of Archaeological Importance	1.28 - 30
Whole Inset Plan Area	Limestone Ridges Landscape Character Area	1.33
	Rural Priority Area (RPA)	3.1
	Site of Nature Conservation Interest	1.35 - 36
	Housing : Committed Site	2.1
	Employment : Committed Site	3.2 - 3.3
	North Dorset Cycleway	4.10
	Footway Provision	5.33

North Dorset
DISTRICT COUNCIL

Nordon, Salisbury Road, Blandford Forum, Dorset DT11 7LL
 Telephone (01258) 454111 • Fax (01258) 480179

NORTH DORSET DISTRICT - WIDE LOCAL PLAN
(1st Revision)

© Crown copyright and database rights
2013 Ordnance Survey LA100018415

Scale 50m Adopted: Jan. 2003

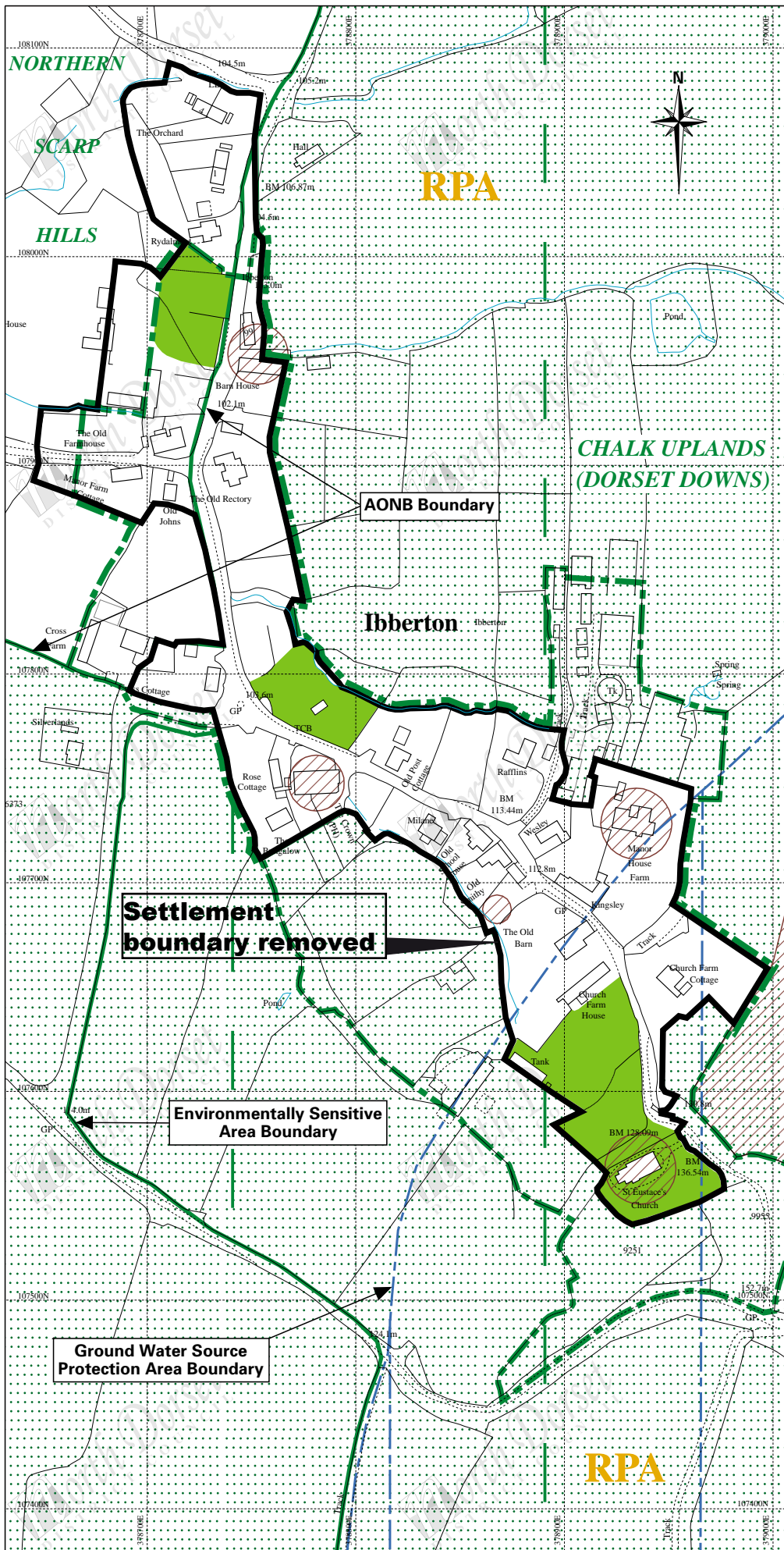

IBBERTON		PROPOSALS MAP
		INSET No. 20
		Policy Ref:
	Settlement Boundary	1.7
	Important Open or Wooded Areas	1.9
	Ground Water Source Protection Area	1.16
	Conservation Area	1.24 - 27
	Sites of Archaeological Importance	1.28 - 30
	Area of Outstanding Natural Beauty (AONB)	1.32
Whole Inset Plan Area	Part Chalk Uplands and Part Northern Scarp Hills Landscape Character Areas	1.33
	Rural Priority Area (RPA)	3.1
	Environmentally Sensitive Area	1.33

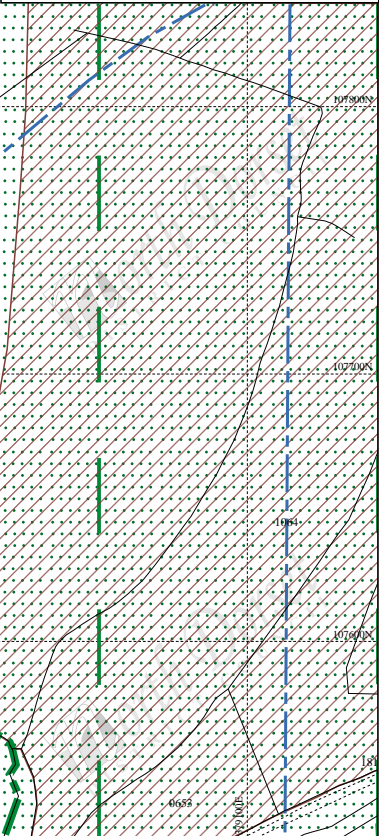

North Dorset
DISTRICT COUNCIL

Nordon, Salisbury Road, Blandford Forum, Dorset DT11 7LL
 Telephone (01258) 454111 Fax (01258) 480179

NORTH DORSET DISTRICT - WIDE LOCAL PLAN (1st Revision)











© Crown copyright and database rights 2013 Ordnance Survey LA100018415

0 50m Adopted: Jan. 2003

IWERNE COURTNEY (SHROTON)

PROPOSALS MAP

INSET No. **21**

	Existing Distributor Route	Para.1.32
	Regular Frequency Bus Route	Para.1.32
	Settlement Boundary	1.7
	Important Open or Wooded Areas	1.9
	River Valley Area	1.12
	Conservation Area	1.24-27
	Sites of Archaeological Importance	1.28-30
	Area of Outstanding Natural Beauty	1.32
	Environmentally Sensitive Area	1.33
Whole Inset Plan Area	Part Chalk Uplands Part Blackmore Vale Landscape Character Area	1.33
	Wessex Ridgeway	4.10

Settlement boundary removed



BLACKMORE VALE

Iwerne Courtney or Shroton

CHALK UPLANDS (CRANBORNE CHASE)

AONB Boundary

HISTORIC PARK (1.31)

North Dorset DISTRICT COUNCIL
 Nordon, Salisbury Road, Blandford Forum, Dorset DT11 7LL
 ● Telephone (01258) 454111 ● Fax (01258) 480179

NORTH DORSET DISTRICT - WIDE LOCAL PLAN (1st Revision)

© Crown copyright and database rights 2013 Ordnance Survey LA100018415

Scale  **Adopted: Jan. 2003**

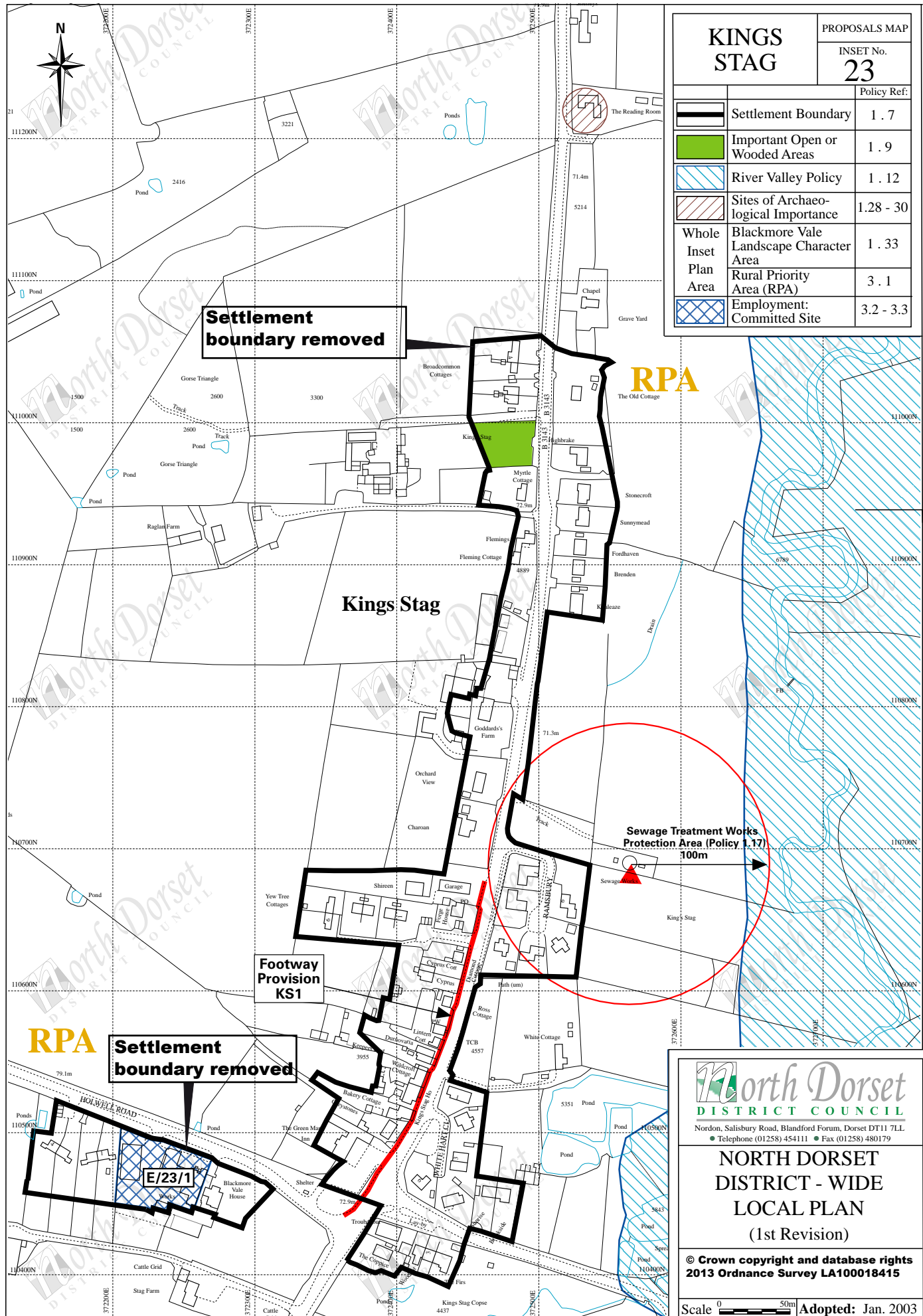

KINGS STAG

PROPOSALS MAP

INSET No.
23

		Policy Ref:
	Settlement Boundary	1. 7
	Important Open or Wooded Areas	1. 9
	River Valley Policy	1. 12
	Sites of Archaeological Importance	1.28 - 30
Whole Inset Plan Area	Blackmore Vale Landscape Character Area	1. 33
	Rural Priority Area (RPA)	3. 1
	Employment: Committed Site	3.2 - 3.3

Settlement boundary removed

RPA
The Old Cottage

Kings Stag

Sewage Treatment Works Protection Area (Policy 1.17) 100m

Footway Provision KS1

Settlement boundary removed

E/23/1

North Dorset DISTRICT COUNCIL

Nordon, Salisbury Road, Blandford Forum, Dorset DT11 7LL
 ● Telephone (01258) 454111 ● Fax (01258) 480179

NORTH DORSET DISTRICT - WIDE LOCAL PLAN (1st Revision)

© Crown copyright and database rights 2013 Ordnance Survey LA100018415

Scale Adopted: Jan. 2003

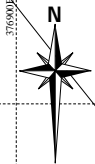
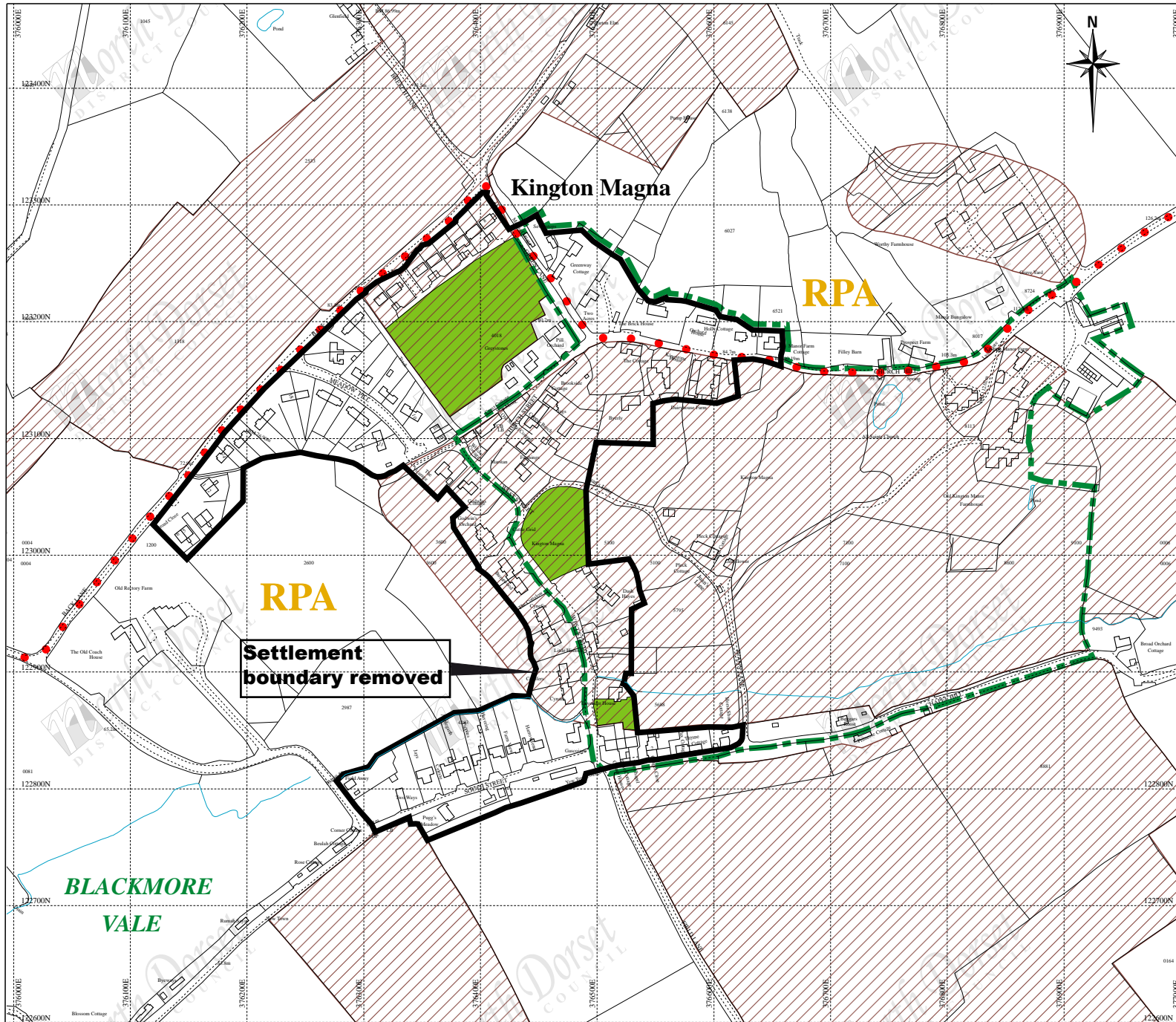

KINGTON MAGNA

PROPOSALS MAP
INSET No. **24**

		Policy Ref:
	Settlement Boundary	1.7
	Important Open or Wooded Areas	1.9
	Conservation Area	1.24 - 27
	Sites of Archaeological Importance	1.28 - 30
Whole Inset Plan Area	Part Limestone Ridges and Part Blackmore Vale Landscape Character Areas	1.33
	Rural Priority Area (RPA)	3.1
	North Dorset Cycleway	4.10

LIMESTONE RIDGES

RPA

Settlement boundary removed

BLACKMORE VALE

North Dorset DISTRICT COUNCIL
Nordon, Salisbury Road, Blandford Forum, Dorset DT11 7LL
Telephone (01258) 454111 • Fax (01258) 480179

NORTH DORSET DISTRICT - WIDE LOCAL PLAN
(1st Revision)

© Crown copyright and database rights 2013 Ordnance Survey LA100018415

Scale Adopted: Jan. 2003