

BLANDFORD ST MARY HOMES Ltd

RESPONDENT ID No. 1596

ISSUE NO. 7

APPENDIX MDB 8

CORRESPONDENCE WITH TRANSPORTATION AUTHORITY

Malcolm Brown

From: Sayers, Wayne <w.sayers@dorsetcc.gov.uk>
Sent: 28 November 2014 10:17
To: rob@akermandesign.co.uk
Cc: Savage, Steve K.
Subject: Proposed speed limit at Blandford St Mary's

Dear Rob,

I have spoken to Andy Brown in our traffic management team about the proposals for the A354 and the desired speed limit for the section of road between the new access and the roundabout. Considering the existing speed limits around the roundabout and the proposals, including street lighting and the new crossing, the conclusion was that a 40mph limit would be the most appropriate.

This will be subject to further consideration as the design progresses and more details become available but 40mph is our considered opinion at the moment and can be used to inform other work.

Kind regards,

Wayne

Wayne Sayers MSc, MIHE, Associate Member RTPI
Transportation Development Management
Dorset County Council

Available Tuesday to Friday.

01305 224161
07917 072924

Dorset County Council - County Hall - Colliton Park - Dorchester - Dorset - DT1 1XJ
(01305) 224161 - w.sayers@dorsetcc.gov.uk - www.dorsetforyou.com/395972

"This e-mail is intended for the named addressee(s) only and may contain information about individuals or other sensitive information and should be handled accordingly. Unless you are the named addressee (or authorised to receive it for the addressee) you may not copy or use it, or disclose it to anyone else. If you have received this email in error, kindly disregard the content of the message and notify the sender immediately. Please be aware that all email may be subject to recording and/or monitoring in accordance with relevant legislation."

Malcolm Brown

From: Rob Akerman <rob@akermandesign.co.uk>
Sent: 21 November 2014 12:51
To: w.sayers@dorsetcc.gov.uk
Subject: FW: Blandford St Mary's
Attachments: 141023 061-10-DRAFT-10-01.pdf

Wayne

Could you let me know your considered view with regards to the referred speed limit below. I recall from our telephone conversation of 11/11/14, you thought a 40mph speed limit on the A354 would be appropriate but were going to consult colleagues before responding formally.

Regards

Rob Akerman
Akerman Infrastructure Solutions Ltd
146 Hendford Hill
Yeovil
Somerset
BA20 2RG
Tel. 01935 508073
Mob. 07807 826914
rob@akermandesign.co.uk

Registered Office: 146 Hendford Hill, Yeovil, Somerset, BA20 2RG. Company Reg. No. 6433101

"Please note that the content of this message is confidential between the original sender and the intended recipient(s) of the message. If you are not an intended recipient and/or have received this message in error, kindly disregard the content of the message and return it to the original sender."

From: Rob Akerman [mailto:rob@akermandesign.co.uk]
Sent: 23 October 2014 16:23
To: 'Sayers, Wayne'
Subject: RE: Blandford St Mary's

Wayne

We are now developing our proposals for the internal elements of the site. This will include a noise survey and proposals to mitigate noise pollution if/where required. The proposed speed limit for the A354 and the possible future bypass could have some impact on the post development noise levels.

In your earlier e-mail below, there is reference to our discussion about an appropriate speed limit for the approaches to the Toucan crossing (whether this should be 50mph or 40mph). Our current drawing proposes a 50mph. However, I believe a 40mph limit from south of the southern development access through the existing roundabout to the existing 40mph on the A350 would be most appropriate for the following reasons:

1. The 40mph would support a more significant 'Gateway' from a rural non-lit all purpose road to an illuminated road with other traffic calming measures (central islands and hatched centreline to prevent overtaking).

2. Would provide a safer approach to the Toucan crossing.
3. Would reduce driver confusion with regards to the extent of speed limits in the locality of the existing roundabout. The introduction of a 50mph limit would result in there being 4 different speed limits (30mph, 40mph, 50mph and 60mph) on and around the existing roundabout. A 40mph limit would reduce this to 2 (30mph and 40mph).

Please could you comment on the above and indicate DCC's preferred speed limit for the A354 and the proposed bypass. I attach a copy of our latest draft drawing to refresh your memory with regards to the scheme. Note the internal development layout is still subject to change.

Regards

Rob Akerman

Akerman Infrastructure Solutions Ltd

146 Hendford Hill

Yeovil

Somerset

BA20 2RG

Tel. 01935 508073

Mob. 07807 826914

rob@akermandesign.co.uk

Registered Office: 146 Hendford Hill, Yeovil, Somerset, BA20 2RG. Company Reg. No. 6433101

"Please note that the content of this message is confidential between the original sender and the intended recipient(s) of the message. If you are not an intended recipient and/or have received this message in error, kindly disregard the content of the message and return it to the original sender."

From: Sayers, Wayne [<mailto:w.sayers@dorsetcc.gov.uk>]

Sent: 14 March 2014 14:50

To: Morgan, Carolyne (MorganC@pbworld.com); rob@akermandesign.co.uk

Cc: Savage, Steve K.

Subject: Blandford St Mary's

Hi Carolyne,

Sorry not to get back to you earlier this week.

As far as your suggested approach to the modelling tweaks go I would prefer that the retail impact assessment is used, or that at least there is some adjustment made to take account of trade draw from ASDA. This approach would be more defensible as far as public examination of your TA goes. I tried to attach a copy of the planning and retail statement for the ASDA application taken from the planning application web page but it was too large and got bounced back by your email system. It can be found using the following web link and is on the second page of documents. Paragraph 8.27 relates to Tesco.

http://plansearch2.north-dorset.gov.uk/Planning/dialog.page?org.apache.shale.dialog.DIALOG_NAME=gfplanningsearch&Param=lg.Planning&SDescription=2/2011/1439/PLNG&viewdocs=true

Rob - could you email me the electronic copies of the design and the safety audit. It also might be worth catching up once you've had a chance to review Matthews initial comments below.

I've had a chance to catch up with Matthew Williams with regards to the toucan crossing design and have some initial feedback to go into further iterations of the design which largely reflect what I said at our meeting. It would be useful to get the electronic copies of the drawing and safety audit as we discussed at our meeting.

We are both still uncomfortable that the crossing is so close to the roundabout in terms of safety and queuing back onto the circulatory carriageway as well as the ability to install any meaningful detection loops to serve the crossing. The traffic here is often platooned and arrives in groups of vehicles. The stacking area shown between the toucan and the roundabout would only accommodate a single HGV and traffic will clearly queue back onto the circulatory carriageway. Matthew was unaware of any guidance that restricted moving the roundabout a short distance further from the roundabout. If it were to be moved a bit further to the south (10-20m) then it could still serve a desire line provided that the link through the development is aligned correctly. This could also be re-enforced by reversing the stagger, something that I mentioned in the meeting and which Matthew would not necessarily be opposed to.

Matthew had concerns that the stagger in the shared use approach was not adequate and that it should be extended. This would be possible if the crossing could be moved.

We discussed the possibility of extending the 40mph zone to encompass the roundabout and approaches to further reduce traffic speed - this will need to be considered further.

Ideally the central island would need to be 4m wide. There appears to be room on the south side to increase the width to achieve this.

With regards to the Travel Plan -

Paragraphs 2.4.1, 4.5.2 & 4.5.6 need updating to reflect our conversations regarding the suitability of the pedestrian crossing of the A354.

In line with Chris's comments I would request that vouchers for bus passes / cycle and cycle equipment purchase are provided as part of the welcome pack.

In addition to Chris's comments could I request that there is a slight change or addition to the targets to include a 'reduction in single occupancy car' target. This is to meet our emerging travel plan guidance and to ensure that we have some standardisation and comparison capability between our travel plans.

I won't be about on Monday next week but, aside from a couple of meetings, should be available for the rest of the week if you'd like to discuss any of this further.

Kind regards,

Wayne

Wayne Sayers MSc, MIHE, Associate Member RTPI

Transportation Development Management
Dorset County Council

01305 224161
07917 072924

Dorset County Council - County Hall - Colliton Park - Dorchester - Dorset - DT1 1XJ
(01305) 224161 - w.sayers@dorsetcc.gov.uk - www.dorsetforyou.com/395972

From: Morgan, Carlyne [<mailto:MorganC@pbworld.com>]
Sent: Wed 12 March 2014 11:52
To: Sayers, Wayne
Cc: Walton, Adam; Rob Akerman
Subject: RE: St Mary's Hill, Blandford Forum

Hi Wayne,

I have tried to ring again this morning to discuss my email below, is there any chance you could get back to either myself or Adam about the issues raised?

We are keen to issue the TA addendum but I wanted to see if you were content with the approach we have followed to assess the impact of the junction prior to formally issuing this?

In addition have you had the opportunity to review the TP submitted? I have attached Chris Hooks response to my original email for your information.

I look forward to hearing from you at your earliest convenience.

Kind regards
Carolyne

From: Morgan, Carlyne
Sent: 11 March 2014 10:50
To: 'Sayers, Wayne'
Cc: Walton, Adam; 'Rob Akerman'
Subject: FW: St Mary's Hill, Blandford Forum

Morning Wayne,

Without obtaining the Planning and Retail Statement (RPS December 2011) we have moved forward with an alternative approach to assessing the impact at the Tesco Roundabout. As discussed at the meeting last week, in the likelihood that the Tesco Store Extension is doubtful to come forward due to the recent planning permission received for the Asda Store, we have re run our capacity assessment with the Tesco store extension traffic removed.

We have not removed any traffic as a result of our targets to reduce single vehicle occupancy trips as detailed within our Travel Plan nor have we removed trips at the junction to reflect the likelihood that existing Tesco customer trips will divert to Asda, so it is my opinion that our assessment is still very robust. Consequentially, the junction now works in all forecast years assessments tested.

I have tried to ring you this morning to discuss our approach as I wanted to see what you thought of it prior to submitting our addendum. I am in until 2pm today if you have the opportunity to call. Alternatively, Adam Walton is about all afternoon.

Kind regards
Carolyne

From: Morgan, Carlyne
Sent: 10 March 2014 13:32
To: 'Sayers, Wayne'
Cc: 'Rob Akerman'; Vernon Knapper; Walton, Adam
Subject: St Mary's Hill, Blandford Forum

Good morning Wayne, I hope you are well.

Thank you again for meeting with us all last week to discuss the St Marys Hill Transport Assessment.

At the meeting our main topic of conversation centred around the pedestrian connectivity across the A354, do you have any initial comments yet on those proposals that we left you with?

We are pulling together the addendum of additional information to submit to you but I am struggling to locate the Planning and Retail Statement (RPS December 2011) associated with the Asda development to re-assess the impact of the junction with less of an impact from the Tesco site (as a result of customers moving to the new Asda store). Do you have access to this report?

Kind regards
Carolyne

Carolyne Morgan
BSc(Hons) MSc(Eng) MIHT CMILT
Principal Transportation Planner, Transport Planning and Visualisation
Parsons Brinckerhoff
Riverside Chambers, Castle Street, Taunton, TA1 4AP
44-(0)1823- 281195; Switchboard: 44-(0)1823-281190
morganc@pbworld.com; www.pbworld.com/ea
Think before you print

NOTICE: This communication and any attachments ("this message") may contain confidential information for the sole use of the intended recipient(s). Any unauthorized use, disclosure, viewing, copying, alteration, dissemination or distribution of, or reliance on this message is strictly prohibited. If you have received this message in error, or you are not an authorized recipient, please notify the sender immediately by replying to this message, delete this message and all copies from your e-mail system and destroy any printed copies.

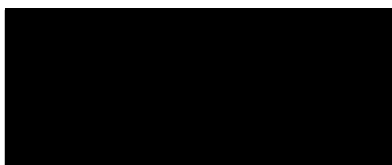

Wayne Sayers MSc, MIHE, Associate Member RTPI
Transportation Development Management
Dorset County Council

01305 224161
07917 072924

Dorset County Council - County Hall - Colliton Park - Dorchester - Dorset - DT1 1XJ
(01305) 224161 - w.sayers@dorsetcc.gov.uk - www.dorsetforyou.com/395972

"This e-mail is intended for the named addressee(s) only and may contain information about individuals or other sensitive information and should be handled accordingly. Unless you are the named addressee (or authorised to receive it for the addressee) you may not copy or use it, or disclose it to anyone else. If you have received this email in error, kindly disregard the content of the message and notify the sender immediately. Please be aware that all email may be subject to recording and/or monitoring in accordance with relevant legislation."

DO NOT SCALE THIS DRAWING

Notes

- 1 Refer to Dwg. AIS061-09-01 for details of the proposed highway infrastructure provision
- 2 The alignment of the footway/cycleway across the proposed development will be subject to the proposed site layout in consultation with Dorset County Council.
- 3 The development boundary shown allows for the possible future construction of the Sperrisychanham future bypass

No	Date	Field Name
00	20.05.14	Field Name
		Issue
		Description

Drafting status
DRAFT

akerman
 148 Handford Hill
 SOVIL
 Southampton
 BA20 2RG
 Tel: 01935 506073
 Email: info@akermandesign.co.uk

Architect --
 Project **Blandford St Mary**
 Drawing **Highway Infrastructure Proposals and Land Requirements**

Scale @ A1 1:500
 Drawn by CGR
 Checked by RA
 Date 20.05.2014

Job No **AIS 061**
 Drg No
 Rev

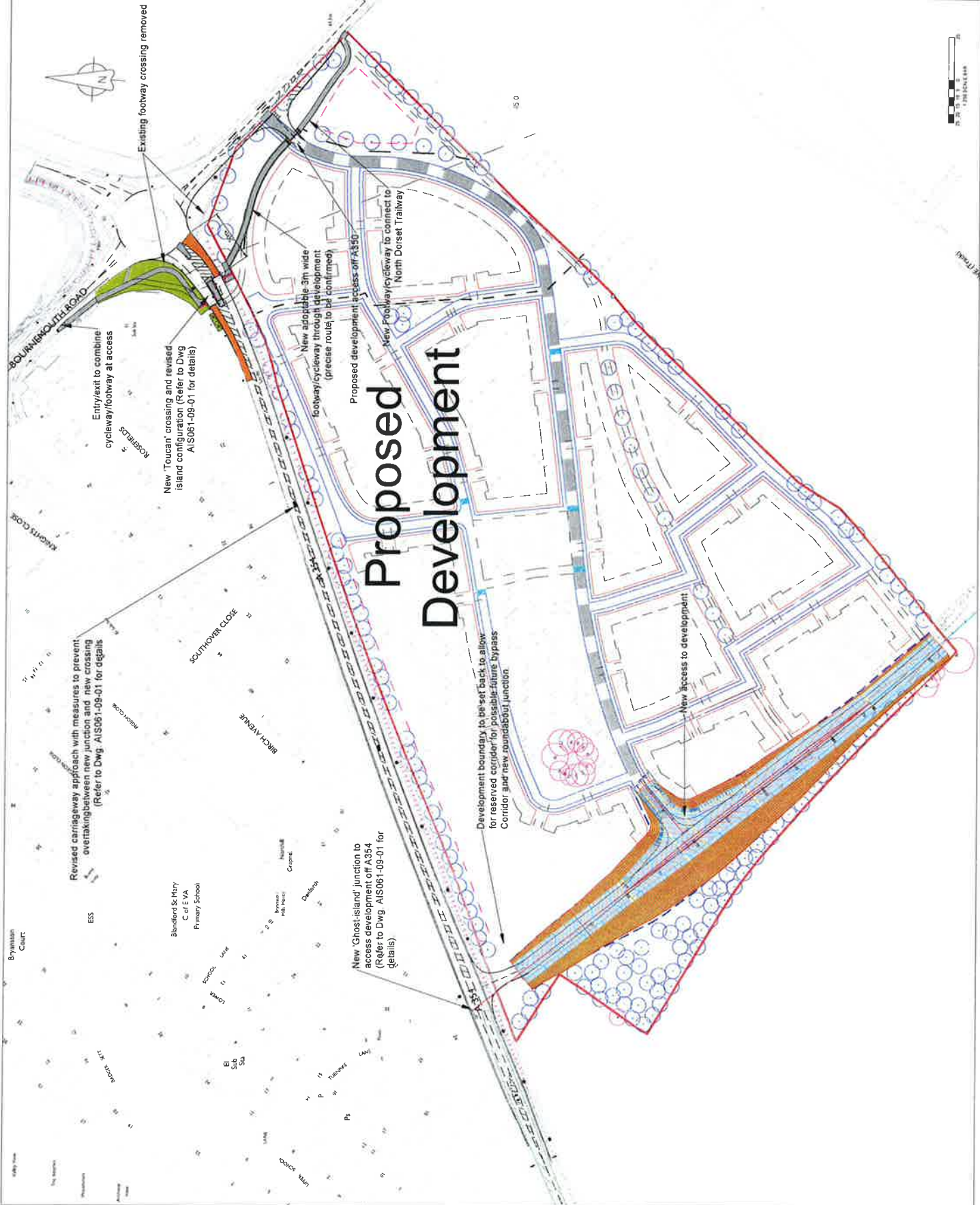

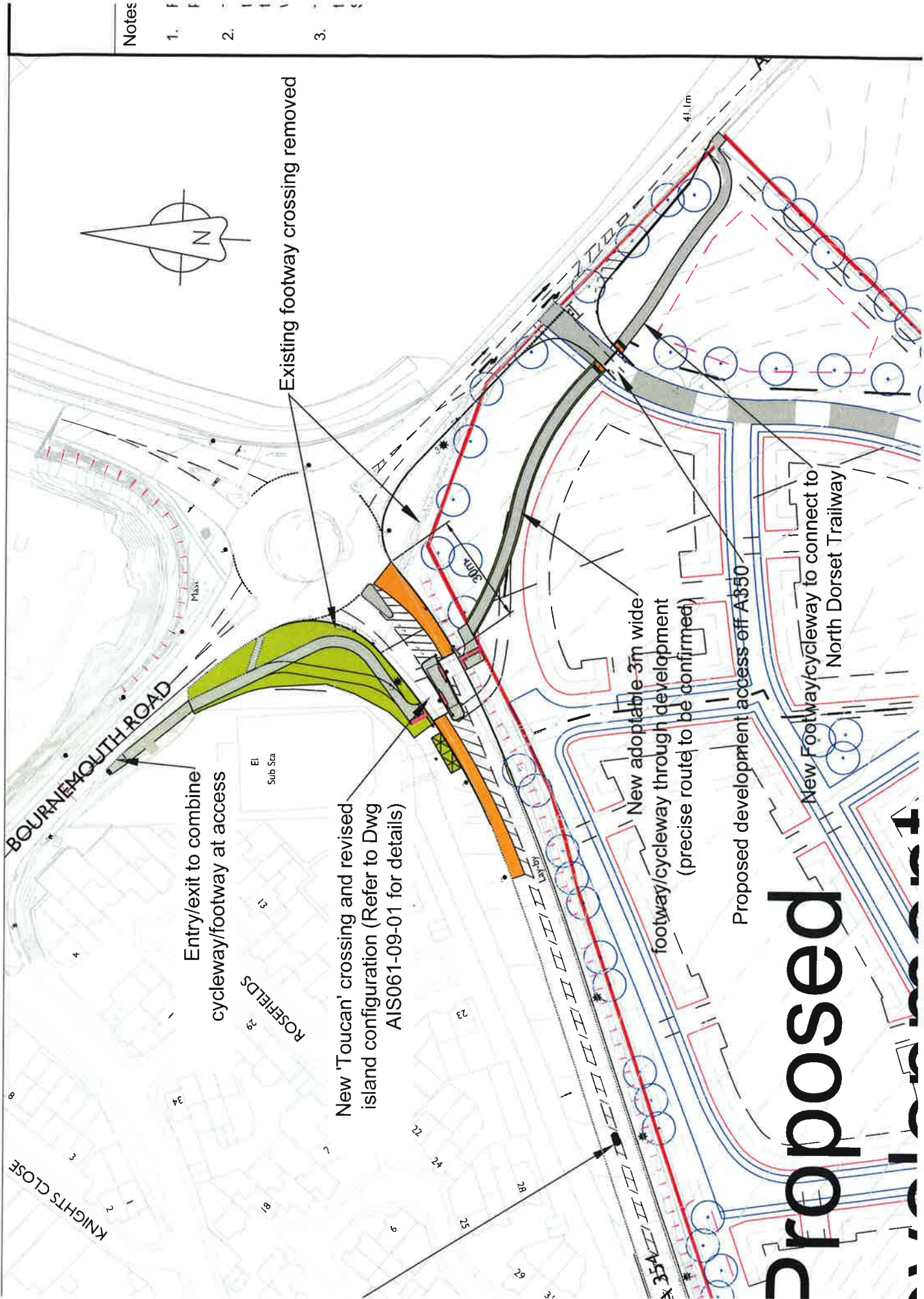

Notes

1. F F
2. - -
3. - -

Proposed

Malcolm Brown

From: Rob Akerman <rob@akermandesign.co.uk>
Sent: 23 October 2014 16:23
To: 'Sayers, Wayne'
Subject: RE: Blandford St Mary's
Attachments: 141023 061-10-DRAFT-10-01.pdf

Wayne

We are now developing our proposals for the internal elements of the site. This will include a noise survey and proposals to mitigate noise pollution if/where required. The proposed speed limit for the A354 and the possible future bypass could have some impact on the post development noise levels.

In your earlier e-mail below, there is reference to our discussion about an appropriate speed limit for the approaches to the Toucan crossing (whether this should be 50mph or 40mph). Our current drawing proposes a 50mph. However, I believe a 40mph limit from south of the southern development access through the existing roundabout to the existing 40mph on the A350 would be most appropriate for the following reasons:

1. The 40mph would support a more significant 'Gateway' from a rural non-lit all purpose road to an illuminated road with other traffic calming measures (central islands and hatched centreline to prevent overtaking).
2. Would provide a safer approach to the Toucan crossing.
3. Would reduce driver confusion with regards to the extent of speed limits in the locality of the existing roundabout. The introduction of a 50mph limit would result in there being 4 different speed limits (30mph, 40mph, 50mph and 60mph) on and around the existing roundabout. A 40mph limit would reduce this to 2 (30mph and 40mph).

Please could you comment on the above and indicate DCC's preferred speed limit for the A354 and the proposed bypass. I attach a copy of our latest draft drawing to refresh your memory with regards to the scheme. Note the internal development layout is still subject to change.

Regards

Rob Akerman

Akerman Infrastructure Solutions Ltd

146 Hendford Hill

Yeovil

Somerset

BA20 2RG

Tel. 01935 508073

Mob. 07807 826914

rob@akermandesign.co.uk

Registered Office: 146 Hendford Hill, Yeovil, Somerset, BA20 2RG. Company Reg. No. 6433101

"Please note that the content of this message is confidential between the original sender and the intended recipient(s) of the message. If you are not an intended recipient and/or have received this message in error, kindly disregard the content of the message and return it to the original sender."

From: Sayers, Wayne [mailto:w.sayers@dorsetcc.gov.uk]
Sent: 14 March 2014 14:50
To: Morgan, Carolyne (MorganC@pbworld.com); rob@akermandesign.co.uk
Cc: Savage, Steve K.
Subject: Blandford St Mary's

Hi Carolyne,

Sorry not to get back to you earlier this week.

As far as your suggested approach to the modelling tweaks go I would prefer that the retail impact assessment is used, or that at least there is some adjustment made to take account of trade draw from ASDA. This approach would be more defensible as far as public examination of your TA goes. I tried to attach a copy of the planning and retail statement for the ASDA application taken from the planning application web page but it was too large and got bounced back by your email system. It can be found using the following web link and is on the second page of documents. Paragraph 8.27 relates to Tesco.

http://plansearch2.north-dorset.gov.uk/Planning/dialog.page?org.apache.shale.dialog.DIALOG_NAME=gfplanningsearch&Param=lg.Planning&SDescription=2/2011/1439/PLNG&viewdocs=true

Rob - could you email me the electronic copies of the design and the safety audit. It also might be worth catching up once you've had a chance to review Matthews initial comments below.

I've had a chance to catch up with Matthew Williams with regards to the toucan crossing design and have some initial feedback to go into further iterations of the design which largely reflect what I said at our meeting. It would be useful to get the electronic copies of the drawing and safety audit as we discussed at our meeting.

We are both still uncomfortable that the crossing is so close to the roundabout in terms of safety and queuing back onto the circulatory carriageway as well as the ability to install any meaningful detection loops to serve the crossing. The traffic here is often platooned and arrives in groups of vehicles. The stacking area shown between the toucan and the roundabout would only accommodate a single HGV and traffic will clearly queue back onto the circulatory carriageway. Matthew was unaware of any guidance that restricted moving the roundabout a short distance further from the roundabout. If it were to be moved a bit further to the south (10-20m) then it could still serve a desire line provided that the link through the development is aligned correctly. This could also be re-enforced by reversing the stagger, something that I mentioned in the meeting and which Matthew would not necessarily be opposed to.

Matthew had concerns that the stagger in the shared use approach was not adequate and that it should be extended. This would be possible if the crossing could be moved.

We discussed the possibility of extending the 40mph zone to encompass the roundabout and approaches to further reduce traffic speed - this will need to be considered further.

Ideally the central island would need to be 4m wide. There appears to be room on the south side to increase the width to achieve this.

With regards to the Travel Plan -

Paragraphs 2.4.1, 4.5.2 & 4.5.6 need updating to reflect our conversations regarding the suitability of the pedestrian crossing of the A354.

In line with Chris's comments I would request that vouchers for bus passes / cycle and cycle equipment purchase are provided as part of the welcome pack.

In addition to Chris's comments could I request that there is a slight change or addition to the targets to include a 'reduction in single occupancy car' target. This is to meet our emerging travel plan guidance and to ensure that we have some standardisation and comparison capability between our travel plans.

I won't be about on Monday next week but, aside from a couple of meetings, should be available for the rest of the week if you'd like to discuss any of this further.

Kind regards,

Wayne

Wayne Sayers MSc, MIHE, Associate Member RTPI
Transportation Development Management
Dorset County Council

01305 224161
07917 072924

Dorset County Council - County Hall - Colliton Park - Dorchester - Dorset - DT1 1XJ
(01305) 224161 - w.sayers@dorsetcc.gov.uk - www.dorsetforyou.com/395972

From: Morgan, Carlyne [<mailto:MorganC@pbworld.com>]
Sent: Wed 12 March 2014 11:52
To: Sayers, Wayne
Cc: Walton, Adam; Rob Akerman
Subject: RE: St Mary's Hill, Blandford Forum

Hi Wayne,

I have tried to ring again this morning to discuss my email below, is there any chance you could get back to either myself or Adam about the issues raised?

We are keen to issue the TA addendum but I wanted to see if you were content with the approach we have followed to assess the impact of the junction prior to formally issuing this?

In addition have you had the opportunity to review the TP submitted? I have attached Chris Hooks response to my original email for your information.

I look forward to hearing from you at your earliest convenience.

Kind regards
Carolyne

From: Morgan, Carlyne
Sent: 11 March 2014 10:50
To: 'Sayers, Wayne'
Cc: Walton, Adam; 'Rob Akerman'
Subject: FW: St Mary's Hill, Blandford Forum

Morning Wayne,

Without obtaining the Planning and Retail Statement (RPS December 2011) we have moved forward with an alternative approach to assessing the impact at the Tesco Roundabout. As discussed at the meeting last week, in

the likelihood that the Tesco Store Extension is doubtful to come forward due to the recent planning permission received for the Asda Store, we have re run our capacity assessment with the Tesco store extension traffic removed.

We have not removed any traffic as a result of our targets to reduce single vehicle occupancy trips as detailed within our Travel Plan nor have we removed trips at the junction to reflect the likelihood that existing Tesco customer trips will divert to Asda, so it is my opinion that our assessment is still very robust. Consequentially , the junction now works in all forecast years assessments tested.

I have tried to ring you this morning to discuss our approach as I wanted to see what you thought of it prior to submitting our addendum. I am in until 2pm today if you have the opportunity to call. Alternatively, Adam Walton is about all afternoon.

Kind regards
Carolyne

From: Morgan, Carolyne
Sent: 10 March 2014 13:32
To: 'Sayers, Wayne'
Cc: 'Rob Akerman'; Vernon Knapper; Walton, Adam
Subject: St Mary's Hill, Blandford Forum

Good morning Wayne, I hope you are well.

Thank you again for meeting with us all last week to discuss the St Mary's Hill Transport Assessment.

At the meeting our main topic of conversation centred around the pedestrian connectivity across the A354, do you have any initial comments yet on those proposals that we left you with?

We are pulling together the addendum of additional information to submit to you but I am struggling to locate the Planning and Retail Statement (RPS December 2011) associated with the Asda development to re-assess the impact of the junction with less of an impact from the Tesco site (as a result of customers moving to the new Asda store). Do you have access to this report?

Kind regards
Carolyne

Carolyne Morgan
BSc(Hons) MSc(Eng) MIHT CMILT
Principal Transportation Planner, Transport Planning and Visualisation
Parsons Brinckerhoff
Riverside Chambers, Castle Street, Taunton, TA1 4AP
44-(0)1823- 281195; Switchboard: 44-(0)1823-281190
morganc@pbworld.com; www.pbworld.com/ea
Think before you print

NOTICE: This communication and any attachments ("this message") may contain confidential information for the sole use of the intended recipient(s). Any unauthorized use, disclosure, viewing, copying, alteration, dissemination or distribution of, or reliance on this message is strictly prohibited. If you have received this message in error, or you are not an authorized recipient, please notify the sender immediately by replying to this message, delete this message and all copies from your e-mail system and destroy any printed copies.



Wayne Sayers MSc, MIHE, Associate Member RTPi

Transportation Development Management

Dorset County Council

01305 224161

07917 072924

Dorset County Council - County Hall - Colliton Park - Dorchester - Dorset - DT1 1XJ

(01305) 224161 - w.sayers@dorsetcc.gov.uk - www.dorsetforyou.com/395972

"This e-mail is intended for the named addressee(s) only and may contain information about individuals or other sensitive information and should be handled accordingly. Unless you are the named addressee (or authorised to receive it for the addressee) you may not copy or use it, or disclose it to anyone else. If you have received this email in error, kindly disregard the content of the message and notify the sender immediately. Please be aware that all email may be subject to recording and/or monitoring in accordance with relevant legislation."

Malcolm Brown

From: Morgan, Carlyne <MorganC@pbworld.com>
Sent: 06 May 2014 08:57
To: w.sayers@dorsetcc.gov.uk
Cc: Rob Akerman
Subject: FW: St Mary's Hill - A354 Crossing Layout.

Morning Wayne,

Thank you for your email below.

Are you able to confirm if you are content with the changes made to the Travel Plan as well?

Kind regards
Carolyne

From: Sayers, Wayne [mailto:w.sayers@dorsetcc.gov.uk]
Sent: 02 May 2014 11:54
To: Rob Akerman
Cc: Morgan, Carlyne; vernonknapper@gmail.com; thijs@knapper.co.uk; DMC@morgancarey.co.uk; Savage, Steve K.
Subject: RE: St Mary's Hill - A354 Crossing Layout.

Dear Rob,

I can confirm that DCC are in agreement that the at grade, toucan crossing, approach can be pursued as a suitable scheme to provide pedestrian access to the proposed site. Following our previous conversation on this you were going to send me an updated plan indicating the distance between the stop line and the rbt on the revised scheme, as the .pdf I already have is not to scale. Once I have this I can confirm that the actual location of the crossing is acceptable to us.

We do have some detailed comments on the layout of the toucan crossing and surrounding areas, looking at island widths, white lining, bollards and the cycle/footway but these will probably be better dealt with should the scheme need to be designed up in detail for delivery.

The revised assessment of the Blandford Road roundabout looks fine and it is clear that the junction will operate much better if the ASDA store is delivered on the other side of Blandford. There is some indication that ASDA are now looking to discharge their reserved matters on this site and hence, increased likelihood that the store will be delivered. It is also true that the new toucan crossing, completing the Sturminster Trailway, would further reduce vehicular impact on the roundabout by providing a safe route for people from the site, as well as those living further to the south east, to visit Tesco and the town centre.

Kind regards,

Wayne

Wayne Sayers MSc, MIHE, Associate Member RTPi
Transportation Development Management
Dorset County Council

01305 224161
07917 072924

Dorset County Council - County Hall - Colliton Park - Dorchester - Dorset - DT1 1XJ
(01305) 224161 - w.sayers@dorsetcc.gov.uk - www.dorsetforyou.com/395972

From: Rob Akerman [<mailto:rob@akermandesign.co.uk>]
Sent: Thu 01 May 2014 14:11
To: Sayers, Wayne
Cc: MorganC@pbworld.com; vernonknapper@gmail.com; thijs@knapper.co.uk; DMC@morgancarey.co.uk
Subject: FW: St Mary's Hill - A354 Crossing Layout.

Wayne

Have you had an opportunity to the Traffic Addendum for the proposed St Mary's Hill Development (issued 8/4/14). We are aiming to issue a planning application to NDDC In order to meet critical dates relating to the NDDC Local Plan. We need to do this as soon as possible but the application relies on feedback from DCC with regards to the highway proposal. Please can you contact me (mobile preferably) as soon as you can to confirm when a response from DCC is likely to be received. Note, e-mail below of particular importance are your comments relating to the at grade crossing.

Regards

Rob Akerman

Akerman Infrastructure Solutions Ltd

146 Hendford Hill

Yeovil

Somerset

BA20 2RG

Tel. 01935 508073

Mob. 07807 826914

rob@akermandesign.co.uk

Registered Office: 146 Hendford Hill, Yeovil, Somerset, BA20 2RG. Company Reg. No. 6433101

"Please note that the content of this message is confidential between the original sender and the intended recipient(s) of the message. If you are not an intended recipient and/or have received this message in error, kindly disregard the content of the message and return it to the original sender."

From: Rob Akerman [<mailto:rob@akermandesign.co.uk>]
Sent: 14 April 2014 16:12
To: w.sayers@dorsetcc.gov.uk; s.k.savage@dorsetcc.gov.uk
Cc: MorganC@pbworld.com
Subject: FW: St Mary's Hill - A354 Crossing Layout.

Wayne

I appreciate you may have not had a chance to review all of the Traffic Addendum which was issued recently by PB on 8/4/14. However, our primary concern at this stage is to ensure we have a feasible solution in principle for the A354 pedestrian crossing (one which addresses DCC's comments relating to the earlier Transport Assessment. We agree that an acceptable crossing is essential and will be the primary driver to the scheme being developed further or not. Is it possible you could provide any major concerns or comments specifically relating to Dwg No. AIS061-07-01-Rev00 – At Grade Controlled Pedestrian Crossing (Option 3) as soon as convenient. We are ready to undertake an Environmental Impact assessment but can only risk doing this once we are confident the pedestrian crossing requirements have been met.

Regards

Rob Akerman

Akerman Infrastructure Solutions Ltd

146 Hendford Hill

Yeovil

Somerset

BA20 2RG

Tel. 01935 508073

Mob. 07807 826914

rob@akermandesign.co.uk

Registered Office: 146 Hendford Hill, Yeovil, Somerset, BA20 2RG. Company Reg. No. 6433101

"Please note that the content of this message is confidential between the original sender and the intended recipient(s) of the message. If you are not an intended recipient and/or have received this message in error, kindly disregard the content of the message and return it to the original sender."

From: Rob Akerman [<mailto:rob@akermandesign.co.uk>]
Sent: 31 March 2014 07:19
To: w.sayers@dorsetcc.gov.uk; 'm.r.williams@dorsetcc.gov.uk'
Subject: St Mary's Hill - A354 Crossing Layout.

Wayne/ Matthew <<...>>

Please find attached Dwg Nos. AIS061-07-01 (Option 3) which includes our current proposals for the crossing on the A354. The proposal addresses your concern with regards to the proximity of the crossing to the roundabout. The crossing has been relocated a further 10m from the roundabout as discussed with Matthew. The drawing will be included in the traffic addendum. I understand the delivery of this has been delayed due to difficulty finding the relevant information from the Asda planning documents so I have forwarded the drawing separately so you can review sooner if possible.

Regards

Rob Akerman

Akerman Infrastructure Solutions Ltd

146 Hendford Hill

Yeovil

Somerset

BA20 2RG

Tel. 01935 508073

Mob. 07807 826914

rob@akermadesign.co.uk

Registered Office: 146 Hendford Hill, Yeovil, Somerset, BA20 2RG. Company Reg. No. 6433101

"Please note that the content of this message is confidential between the original sender and the intended recipient(s) of the message. If you are not an intended recipient and/or have received this message in error, kindly disregard the content of the message and return it to the original sender."

"This e-mail is intended for the named addressee(s) only and may contain information about individuals or other sensitive information and should be handled accordingly. Unless you are the named addressee (or authorised to receive it for the addressee) you may not copy or use it, or disclose it to anyone else. If you have received this email in error, kindly disregard the content of the message and notify the sender immediately. Please be aware that all email may be subject to recording and/or monitoring in accordance with relevant legislation."

NOTICE: This communication and any attachments ("this message") may contain confidential information for the sole use of the intended recipient(s). Any unauthorized use, disclosure, viewing, copying, alteration, dissemination or distribution of, or reliance on this message is strictly prohibited. If you have received this message in error, or you are not an authorized recipient, please notify the sender immediately by replying to this message, delete this message and all copies from your e-mail system and destroy any printed copies.

Malcolm Brown

From: Sayers, Wayne <w.sayers@dorsetcc.gov.uk>
Sent: 02 May 2014 11:54
To: Rob Akerman
Cc: MorganC@pbworld.com; vernonknapper@gmail.com; thijs@knapper.co.uk; DMC@morgancarey.co.uk; Savage, Steve K.
Subject: RE: St Mary's Hill - A354 Crossing Layout.

Dear Rob,

I can confirm that DCC are in agreement that the at grade, toucan crossing, approach can be pursued as a suitable scheme to provide pedestrian access to the proposed site. Following our previous conversation on this you were going to send me an updated plan indicating the distance between the stop line and the rbt on the revised scheme, as the .pdf I already have is not to scale. Once I have this I can confirm that the actual location of the crossing is acceptable to us.

We do have some detailed comments on the layout of the toucan crossing and surrounding areas, looking at island widths, white lining, bollards and the cycle/footway but these will probably be better dealt with should the scheme need to be designed up in detail for delivery.

The revised assessment of the Blandford Road roundabout looks fine and it is clear that the junction will operate much better if the ASDA store is delivered on the other side of Blandford. There is some indication that ASDA are now looking to discharge their reserved matters on this site and hence, increased likelihood that the store will be delivered. It is also true that the new toucan crossing, completing the Sturminster Trailway, would further reduce vehicular impact on the roundabout by providing a safe route for people from the site, as well as those living further to the south east, to visit Tesco and the town centre.

Kind regards,

Wayne

Wayne Sayers MSc, MIHE, Associate Member RTPI

Transportation Development Management
Dorset County Council

01305 224161
07917 072924

Dorset County Council - County Hall - Colliton Park - Dorchester - Dorset - DT1 1XJ
(01305) 224161 - w.sayers@dorsetcc.gov.uk - www.dorsetforyou.com/395972

From: Rob Akerman [mailto:rob@akermadesign.co.uk]
Sent: Thu 01 May 2014 14:11
To: Sayers, Wayne
Cc: MorganC@pbworld.com; vernonknapper@gmail.com; thijs@knapper.co.uk; DMC@morgancarey.co.uk
Subject: FW: St Mary's Hill - A354 Crossing Layout.

Wayne

Have you had an opportunity to the Traffic Addendum for the proposed St Mary's Hill Development (issued 8/4/14). We are aiming to issue a planning application to NDDC In order to meet critical dates relating to the NDDC Local Plan. We need to do this as soon as possible but the application relies on feedback from DCC with regards to the highway proposal. Please can you contact me (mobile preferably) as soon as you can to confirm when a response from DCC is likely to be received. Note, e-mail below of particular importance are your comments relating to the at grade crossing.

Regards

Rob Akerman

Akerman Infrastructure Solutions Ltd

146 Hendford Hill

Yeovil

Somerset

BA20 2RG

Tel. 01935 508073

Mob. 07807 826914

rob@akermandesign.co.uk

Registered Office: 146 Hendford Hill, Yeovil, Somerset, BA20 2RG. Company Reg. No. 6433101

"Please note that the content of this message is confidential between the original sender and the intended recipient(s) of the message. If you are not an intended recipient and/or have received this message in error, kindly disregard the content of the message and return it to the original sender."

From: Rob Akerman [<mailto:rob@akermandesign.co.uk>]
Sent: 14 April 2014 16:12
To: w.sayers@dorsetcc.gov.uk; s.k.savage@dorsetcc.gov.uk
Cc: MorganC@pbworld.com
Subject: FW: St Mary's Hill - A354 Crossing Layout.

Wayne

I appreciate you may have not had a chance to review all of the Traffic Addendum which was issued recently by PB on 8/4/14. However, our primary concern at this stage is to ensure we have a feasible solution in principle for the A354 pedestrian crossing (one which addresses DCC's comments relating to the earlier Transport Assessment. We agree that an acceptable crossing is essential and will be the primary driver to the scheme being developed further or not. Is it possible you could provide any major concerns or comments specifically relating to Dwg No. AIS061-07-01-Rev00 – At Grade Controlled Pedestrian Crossing (Option 3) as soon as convenient. We are ready to undertake an Environmental Impact assessment but can only risk doing this once we are confident the pedestrian crossing requirements have been met.

Regards

Rob Akerman

Akerman Infrastructure Solutions Ltd

146 Hendford Hill

Yeovil

Somerset

BA20 2RG

Tel. 01935 508073

Mob. 07807 826914

rob@akermandesign.co.uk

Registered Office: 146 Hendford Hill, Yeovil, Somerset, BA20 2RG. Company Reg. No. 6433101

"Please note that the content of this message is confidential between the original sender and the intended recipient(s) of the message. If you are not an intended recipient and/or have received this message in error, kindly disregard the content of the message and return it to the original sender."

From: Rob Akerman [<mailto:rob@akermandesign.co.uk>]

Sent: 31 March 2014 07:19

To: w.sayers@dorsetcc.gov.uk; 'm.r.williams@dorsetcc.gov.uk'

Subject: St Mary's Hill - A354 Crossing Layout.

Wayne/ Matthew <<...>>

Please find attached Dwg Nos. AIS061-07-01 (Option 3) which includes our current proposals for the crossing on the A354. The proposal addresses your concern with regards to the proximity of the crossing to the roundabout. The crossing has been relocated a further 10m from the roundabout as discussed with Matthew. The drawing will be included in the traffic addendum. I understand the delivery of this has been delayed due to difficulty finding the relevant information from the Asda planning documents so I have forwarded the drawing separately so you can review sooner if possible.

Regards

Rob Akerman

Akerman Infrastructure Solutions Ltd

146 Hendford Hill

Yeovil

Somerset

BA20 2RG

Tel. 01935 508073

Mob. 07807 826914

rob@akermadesign.co.uk

Registered Office: 146 Hendford Hill, Yeovil, Somerset, BA20 2RG. Company Reg. No. 6433101

"Please note that the content of this message is confidential between the original sender and the intended recipient(s) of the message. If you are not an intended recipient and/or have received this message in error, kindly disregard the content of the message and return it to the original sender."

"This e-mail is intended for the named addressee(s) only and may contain information about individuals or other sensitive information and should be handled accordingly. Unless you are the named addressee (or authorised to receive it for the addressee) you may not copy or use it, or disclose it to anyone else. If you have received this email in error, kindly disregard the content of the message and notify the sender immediately. Please be aware that all email may be subject to recording and/or monitoring in accordance with relevant legislation."