

BLANDFORD ST MARY HOMES Ltd

RESPONDENT ID No. 1596

ISSUE NO. 7

APPENDIX MDB 5

TREE REPORT AND ARBORICULTURAL IMPACT ASSESSMENT

Mark Hinsley Arboricultural Consultants Ltd.

MSc Res Man (Arb), OND (Arb), M.Arbor. A.

Established 1994



Reg. Office Address: Wessex House, Wimborne, Dorset, England BH21 1PB Company Reg. No. 07232825

Tel: 01202 840819 Email: markhinsley@treeadvice.info

VAT Reg. No. 730399627

Our ref:MH/St Mary'sHill/Tres/3416

16th January 2015

Mrs L Abbott
Langbourne House
Pimperne
BLANDFORD
Dorset
DT11 8BT

Dear Mrs Abbott

TREES AT ST MARY'S HILL, BLANDFORD

Brief: Inspect the trees shown on the supplied plan at St Mary's Hill, Blandford. Comment upon their condition and indicate the constraints they may place upon any proposed development. Comment upon the Arboricultural Impact of the proposed layout shown on the supplied Morgan Carey site plan.

Date of Inspection: 14.1.2015

Inspected by: Mark Hinsley, MSc.Res.Man (Arb.), OND (Arb.), M.Arbor.A.
Heather Hinsley ANCH. NCH.

Survey method: Ground level visual & desktop

TREE SURVEY FOR ST MARY'S HILL, BLANDFORD

Survey Technique

The surveyed trees were visually assessed from ground level as far as access allowed. No climbing inspections or invasive examination techniques were carried out. Access to some trees was restricted, in such cases the descriptions of the trees given in the survey schedule are subject to the tree being free of significant defects that were not clearly visible. Detail on the individual trees assessed is given in the

Consultant: Alison Parish, BSc. Hons (Ecology), M.Hort. (RHS)
Arboriculturalist: John Christopher, FdScArb, HNC Building Studies
Technician: Rebecca Hinsley FdArt & Design
Support staff: Claire Perry, Teresa O'Neale

e-mail: alisonparish@treeadvice.info

e-mail: cad@treeadvice.info

e-mail: enquiries@treeadvice.info

T	Name & Species	Hgt	Dbh	RPA	B/S	C/C	Age	R/C	Cat	General Observations
3	Lime <i>Tilia x europaea</i>	20	830	9.9	N4.5 E7 S4.5 W7 FSB S2	0 5 0 0	M	40+	A	Ploughing line = 5m. Historic group.
4	Lime <i>Tilia x europaea</i>	4	610	7.2	N1 E1 S1 W4 FSB W3	0 0 0 0	M	40+	C	Severe lost top. Historic group. Could be allowed to continue in group as a pollard.
5	Lime <i>Tilia x europaea</i>	16	660	7.8	N4 E3 S3 W4 FSB W6	8 8 8 8	M	40+	B	Historic group. Ploughing line = 5m. Lost top. Could continue in group as pollard.
6	Lime <i>Tilia x europaea</i>	14	630	7.5	N7 E2 S5 W5 FSB n/a	5 1 1 1	M	40+	B	Historic group. Ploughing line = 6m. Lost top. Dense epicormic growth. Retain as pollard.
7	Lime <i>Tilia x europaea</i>	23	880	10.5	N6 E4 S9 W5 FSB S3	10 1 1 1	M	40+	A	Historic group. Ploughing line = 8m.
8	Lime <i>Tilia x europaea</i>	17	600	7.2	N1 E6 S6 W2 FSB S4	5 1 1 1	M	40+	B	Historic group. Some top die back. Ploughing line = 8m.
9	Lime <i>Tilia x europaea</i>	18	690	8.4	N3 E9 S3 W3 FSB E2	0 3 0 0	M	40+	B	Historic group. Ploughing line = 9m. Partly suppressed.
10	Lime <i>Tilia x europaea</i>	24	740	9	N3 E7 S3 W3 FSB 4	8 0 8 8	M	40+	B	Historic group. Ploughing line = 8m. Part suppressed.
11	Lime <i>Tilia x europaea</i>	22	750	9.0	N4 E7 S3 W4 FSB E4	6 0 6 6	M	40+	B	Historic group. Ploughing line = 8m. Close grown.

Consultant: Alison Parish, BSc. Hons (Ecology), M.Hort. (RHS)
 Arboriculturalist: John Christopher, FdScArb, HNC Building Studies
 Technician: Rebecca Hinsley FdArt & Design
 Support staff: Claire Perry, Teresa O'Neale

e-mail: alisonparish@treeadvice.info
 e-mail: cad@treeadvice.info
 e-mail: enquiries@treeadvice.info

In the survey schedule above we have recorded the distance from the trees to the existing regular ploughing line as this, at present, is the true limit of RPAs.

Historically there was another, similar group to the north of this group however old maps and photographs indicate it was standing on what is now the line of the A354 Blandford By-pass.

The other important trees on this site are two oaks on the south-eastern boundary. One is a good young oak (T18) and the other is a fully mature veteran oak (T19). There is also a large mature Poplar in the south-eastern corner of the site that is in a prominent location.

In places around the boundary are clumps of ash that have regenerated from coppice stools within the hedge line that have been allowed to grow unchecked for a while, sound management of these clumps is to re-coppice them back into the hedge.

Arboricultural Impact Assessment

We were delighted to see the space that Morgan Carey have incorporated into their proposal around the group of Limes and the Oak trees. It is clear that they have fully taken on board the need to protect these important trees and have provided meaningful space in which to do so.

It is also of importance that the switch from agriculture to residential will result in a cessation of ploughing operations within the RPAs of all the retained trees and hedgerows in and around this site, the consequence of which is that the trees will have a better rooting environment in the future than they have now.

From an Arboricultural point of view we thoroughly recommend the Morgan Carey proposal as having a positive impact upon the important retained trees on this site.

The space provided by Morgan Carey for the trees should make it reasonably straight forward to protect them during construction works, however, it would be entirely reasonable for the Local Planning Authority to place a condition upon any planning approval for the production of an Arboricultural Method Statement prior to any works commencing on site.

If you require any further information at this stage please do not hesitate to contact us.

Yours sincerely

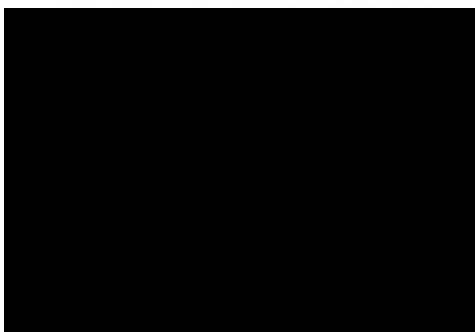

Mark Hinsley
Morgan Carey Architects

Consultant: Alison Parish, BSc. Hons (Ecology), M.Hort. (RHS)
Arboriculturalist: John Christopher, FdScArb, HNC Building Studies
Technician: Rebecca Hinsley FdArt & Design
Support staff: Claire Perry, Teresa O'Neale

e-mail: alisonparish@treeadvice.info
e-mail: cad@treeadvice.info
e-mail: enquiries@treeadvice.info

BS 5437:2012
 CATEGORY X TREES
 CATEGORY Y TREES
 CATEGORY Z TREES
 PROTECTION AREA CUT A, B & C
 FLOODING LINE

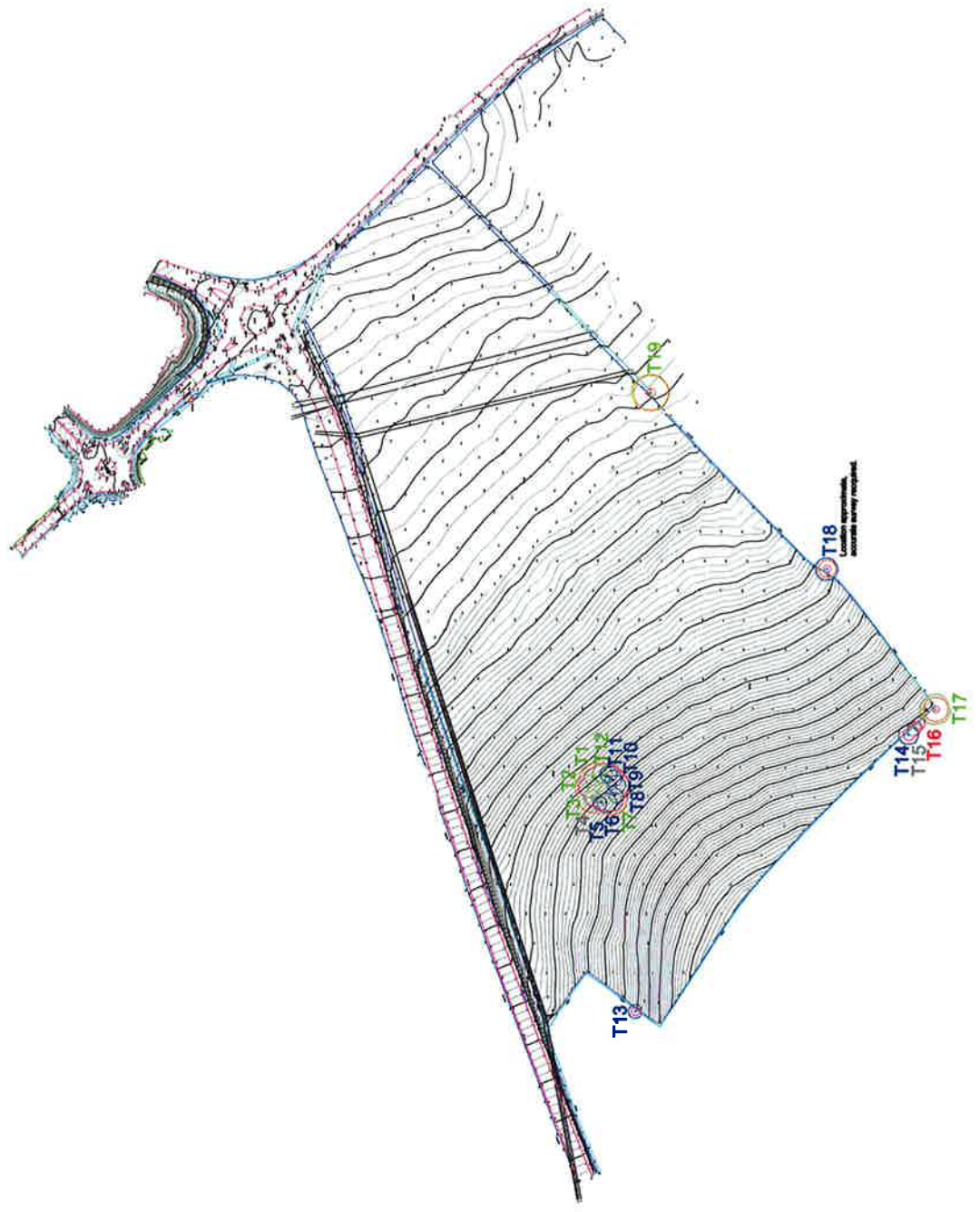

project: ST MARY'S HILL
 BLANDFORD ST MARY
 client: MRS L ABBOTT
 drawing title: TREE SURVEY AND CONSTRAINTS PLAN

MARK HINSLEY
ARBORCULTURAL
CONSULTANTS LTD
 WESSLE HOUSE, WIMBORNE, DORSET BH21 1PH
 Website: www.mhconsultants.co.uk
 E-Mail: markhinsley@mhconsultants.co.uk
 Tel: 01202 655901
 Fax: 01202 655901

date:	see next bar	revision:	A3
drawn by:	BL	checked by:	ML/DJ/S
drawing number:			